

Body Specifications

Unit: mm (in)

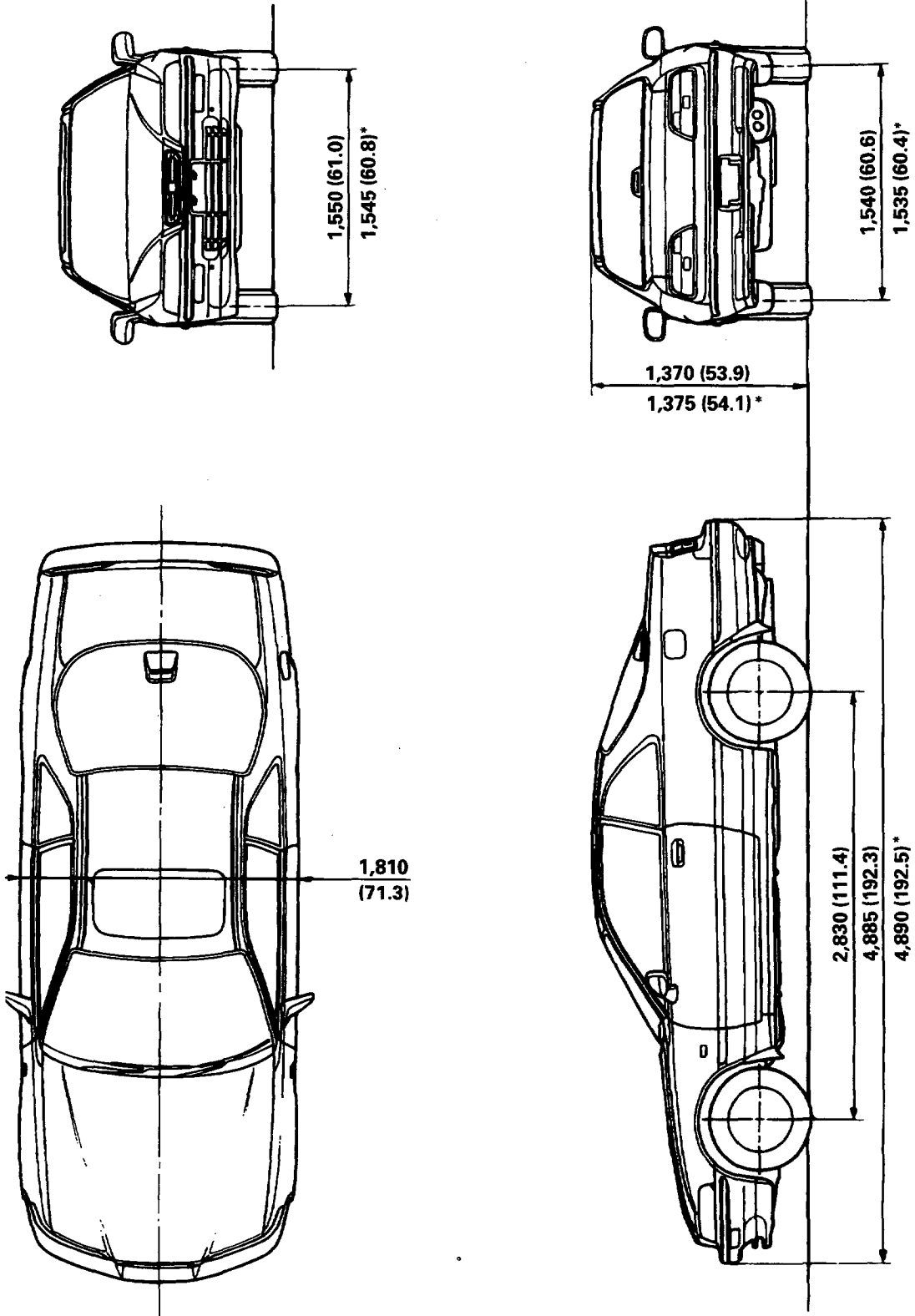

*: KY

Maintenance

Lubrication Points.....4-2

Maintenance Schedule.....4-4



Lubrication Points

For the details of lubrication points and types of lubricants to be applied, refer to the Illustrated Index and various work procedures (such as Assembly/Reassembly, Replacement, Overhaul, Installation, etc.) contained in each section.

No.	LUBRICATION POINTS	LUBRICANT
1	Engine	API Service Grade: SF, SG or SH fuel efficient oil SAE Viscosity: See chart below
2	Transmission	Manual API Service Grade: SF or SG SAE Viscosity: 10 W-30 or 10 W-40
		Automatic Honda Premium Formula or DEXRON® II Automatic transmission fluid (ATF)
3	Brake Line	Brake fluid DOT3 or DOT4
4	Clutch Line	Brake fluid DOT3 or DOT4
5	Power steering gearbox	Steering grease P/N 08733-B070E
6	Shift lever pivots (Manual transmission)	Grease with molybdenum disulfide
7	Release fork (Manual transmission)	Urea Grease UM264 P/N 41211-PY5-305
8 9 10 11 12 13 14 15 16 17 18 19 20 21	Steering boots Throttle cable end Steering ball joints Select lever (Automatic transmission) Pedal linkage Intermediate shaft Brake master cylinder pushrod Trunk hinges Door hinges upper and lower Door opening detents Fuel fill lid Hood hinges and hood latch Clutch master cylinder pushrod (Manual transmission) Change rod joint (Manual transmission)	Multi-purpose grease
22	Caliper Piston seal, Dust seal, Caliper pin, Piston	Silicone grease
23	Power steering system	Honda power steering fluid-V
24	Differential	Differential oil Hypoid gear oil API classified GL4 or GL5 Viscosity: SAE90: above -18 °C (0 °F) SAE 80 W90: below -18 °C (0 °F)
25	Air conditioning compressor	Compressor oil: ND-OIL8 P/N 38899-PR7-003 (For Refrigerant: HFC-134a (R-134a))

Recommended Engine Oil
API Service Grade: SF, SG or SH fuel efficient oil.
Select the oil for the car according to this chart.

CAUTION:

Used engine oil may causes skin cancer if repeatedly left in contact with the skin for prolonged periods. Although this is unlikely unless you handle used oil on a daily basis, it is still advisable to thoroughly wash your hands with soap and water as soon as possible after handling used oil.

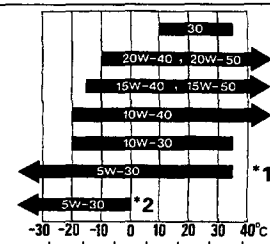

*1: For cars with catalytic converter
*2: For cars without catalytic converter

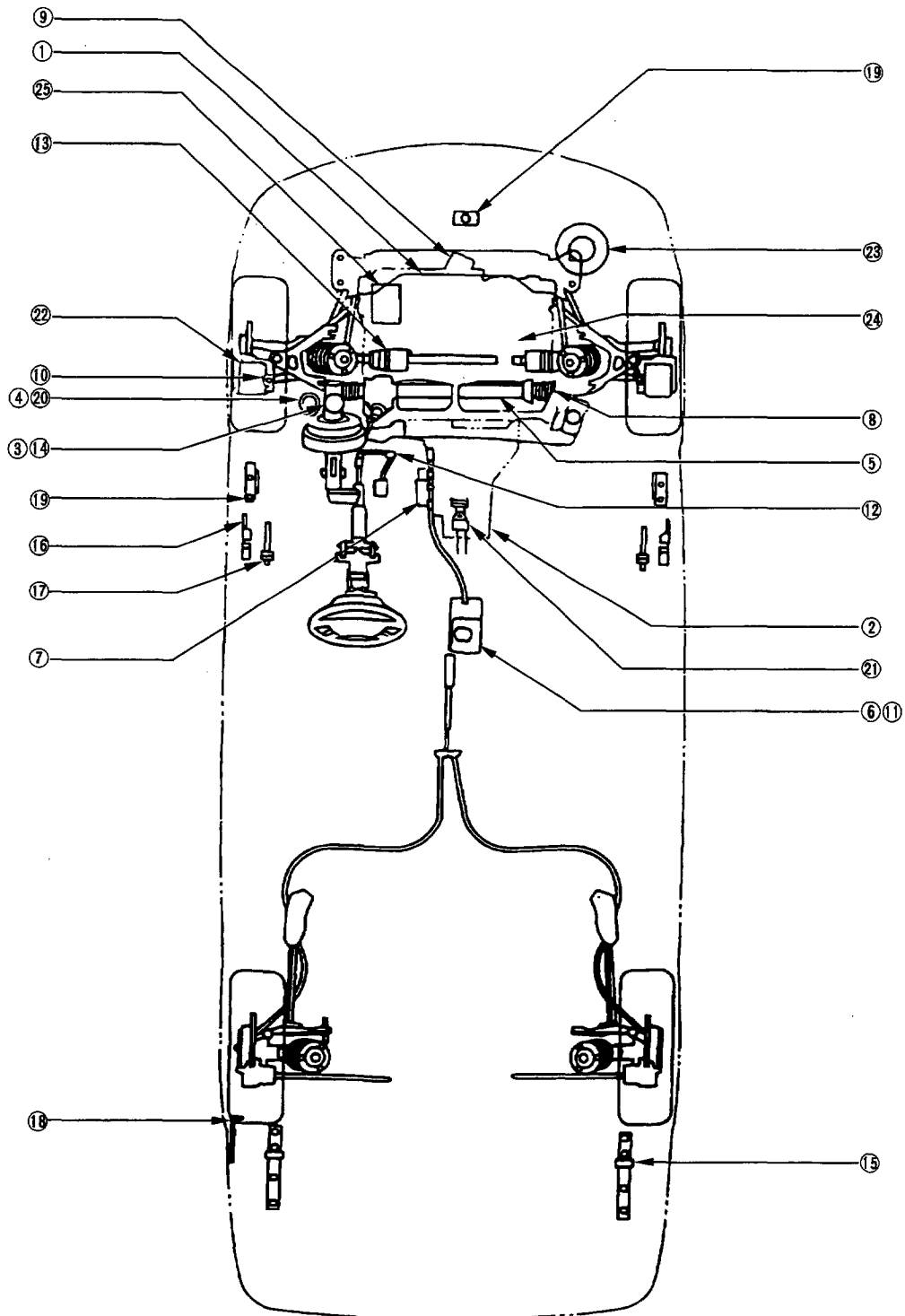

Maintenance Schedule

R=Replace I=Inspect After inspection, clean, adjust, fill up, repair or replace if necessary.

Service at the interval listed x 1,000 km (or miles) or after that number of months, whichever comes first.	x 1,000 km	20	40	60	80	100	120	140	160	180	200
	x 1,000 miles	12	24	36	48	60	72	84	96	108	120
	months	12	24	36	48	60	72	84	96	108	120
● Engine oil and oil filter	For European models	Replace every 10,000 km (6,000 miles) or 12 months									
	For other than European models	Replace every 10,000 km (6,000 miles) or 6 months									
● Transmission oil	For European models			R			R			R	
	For other than European models		R		R		R		R		R
Front differential oil	For European models			R			R			R	
	For other than European models		R		R		R		R		R
Belt tension and conditions (Alternator, Power steering, A/C compressor)			I		I		I		I		I
Timing belt						R					R
Water pump						I					I
Cooling system hoses and connections			I		I		I		I		I
● Engine coolant					R		R		R		R
Spark plugs	For cars with catalytic converter					R ^{*1}					R ^{*1}
	For cars without catalytic converter	R	R	R	R	R	R	R	R	R	R
Ignition timing (For other than European models)			I		I		I		I		I
Air cleaner element	For cars with catalytic converter		R		R		R		R		R
	For cars without catalytic converter	R	R	R	R	R	R	R	R	R	R
Tank, fuel lines and connections			I		I		I		I		I
Fuel filter			R		R		R		R		R
Positive crankcase ventilation valve						I					I
Idle speed and idle CO		I ^{*2}	I ^{*2}	I ^{*2}	I ^{*2}	I	I	I	I	I	I
EGR system (For cars without catalytic converter)			I		I		I		I		I
EGR filter (For cars without catalytic converter)					R				R		
Evaporative emission control system (For other than European models)						I					I

● Day to day care (engine oil, ATF and coolant level) should be done practically according to the owner's manual by the customer.

*1: Replace every 6 years or 100,000 km (60,000 miles), whichever comes first.

*2: For KS model, recommended by manufacturer only: except for KS model, it is required.



R=Replace I=Inspect After inspection, clean, adjust, fill up, repair or replace if necessary.

Service at the interval listed x 1,000 km (or miles) or after that number of months, whichever comes first.	x 1,000 km	20	40	60	80	100	120	140	160	180	200
	x 1,000 miles	12	24	36	48	60	72	84	96	108	120
	months	12	24	36	48	60	72	84	96	108	120
Front brake pads	Inspect every 10,000 km (6,000 miles) or 12 months										
Front brake discs and calipers	I	I	I	I	I	I	I	I	I	I	I
Rear brake discs, calipers and pads		I		I		I		I		I	
Parking brake drums and linings		I		I		I		I		I	
Parking brake operation	I	I		I		I		I		I	
Brake fluid (Including ABS)		R		R		R		R		R	
Brake hoses and lines	I	I	I	I	I	I	I	I	I	I	I
Anti-lock brake system operation	I	I		I		I		I		I	
Anti-lock brake system high pressure hose				R				R			
Exhaust system and condition	I	I	I	I	I	I	I	I	I	I	I
Catalytic converter heat shield (For cars with catalytic converter)					I						I
Suspension components	I	I	I	I	I	I	I	I	I	I	I
Steering function, tie-rod ends, gear box and boots	I	I		I		I		I		I	
Power steering function, hoses and connections	I	I	I	I	I	I	I	I	I	I	I
All fluid levels	Inspect every 10,000 km (6,000 miles) or 12 months										
Battery condition	I	I	I	I	I	I	I	I	I	I	I
Tyres condition, wear and pressure (Including spare)	Inspect every 10,000 km (6,000 miles) or 12 months										
Lights operation and headlight beam	Inspect every 10,000 km (6,000 miles) or 12 months										
Paint damages and body work	I	I	I	I	I	I	I	I	I	I	I
Test drive (Noise, stability, dashboard operations)	I	I	I	I	I	I	I	I	I	I	I
Cleanliness of controls, door handles etc	Inspect after every service										
Supplemental Restraint System	Inspect system 10 years after first registration										

(cont'd)

Maintenance Schedule

(cont'd)

Severe Driving Conditions

The following items must be serviced more frequently on cars normally used under severe driving conditions. Refer to the chart below for the appropriate maintenance intervals.

Severe driving conditions include:

- A: Repeated short distance driving.
- B: Driving in dusty conditions.
- C: Driving in severe cold weather.
- D: Driving in areas using road salt or other corrosive materials.
- E: Driving on rough and/or muddy roads.
- F: Towing a trailer.

R=Replace C=Clean I=Inspect After inspection, clean, adjust, fill up, repair or replace if necessary.

Condition	Maintenance	Operation	Interval	
A B F	Engine oil and oil filter	For European models	R	Every 5,000 km (3,000 miles) or 6 months
		For other than European models	R	Every 5,000 km (3,000 miles) or 3 months
. F	Transmission oil	R	Every 20,000 km (12,000 miles) or 12 months	
. F	Front differential oil	R	Every 20,000 km (12,000 miles) or 12 months	
. B . . E . .	Air cleaner element	For cars with catalytic converter	C	Every 20,000 km (12,000 miles) or 12 months
			R	Every 40,000 km (24,000 miles) or 24 months
		For cars without catalytic converter	C	Every 10,000 km (6,000 miles) or 6 months
			R	Every 20,000 km (12,000 miles) or 12 months
A B . D E F	Front brake discs and calipers	I	Every 10,000 km (6,000 miles) or 6 months	
A B . D E F	Rear brake discs, calipers and pads	I	Every 20,000 km (12,000 miles) or 12 months	
. B C . E .	Power steering system	I	Every 10,000 km (6,000 miles) or 6 months	

Transaxle

Manual Transmission	13-1
Automatic Transmission.....	14-1
Differential	15-1



Manual Transmission

Transmission

Deletion of Secondary Cover13-2

Deletion of Secondary Spring.....13-2



Outline of Model Changes

- The secondary cover has been deleted.
- The secondary spring has been deleted.

Transmission

Deletion of Secondary Cover

The secondary cover is not used on '95 Legend Coupes, so there is no need to remove or install it.

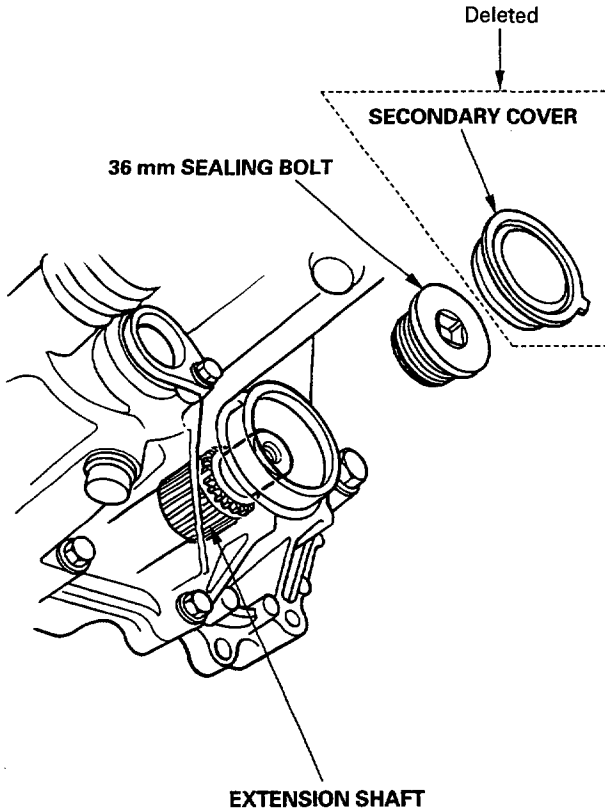

Deletion of Secondary Spring

The secondary spring is not used on '95 Legend Coupes, so there is no need to remove or install it.

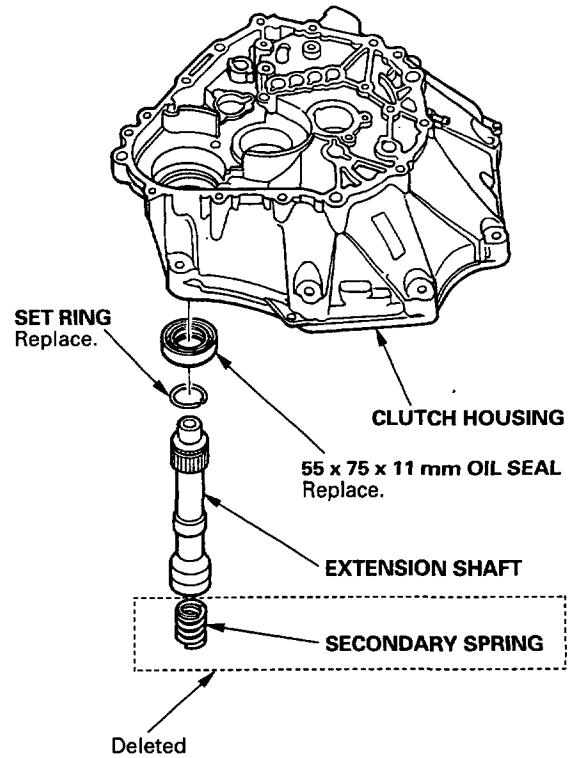

Automatic Transmission

Circuit Diagram 14-2

Transmission

Deletion of Secondary Cover 14-6

Deletion of Secondary Spring 14-6

Deletion of ATF Magnet 14-7

Countershaft

**Disassembly/Inspection/
Reassembly 14-8**

Inspection 14-9



Outline of Model Changes

- The Circuit Diagrams have been modified.
- The Secondary Cover has been deleted.
- The Secondary Spring has been deleted.
- The ATF Magnet has been deleted.
- The Countershaft Inspection has been modified.

Circuit Diagram

LHD:

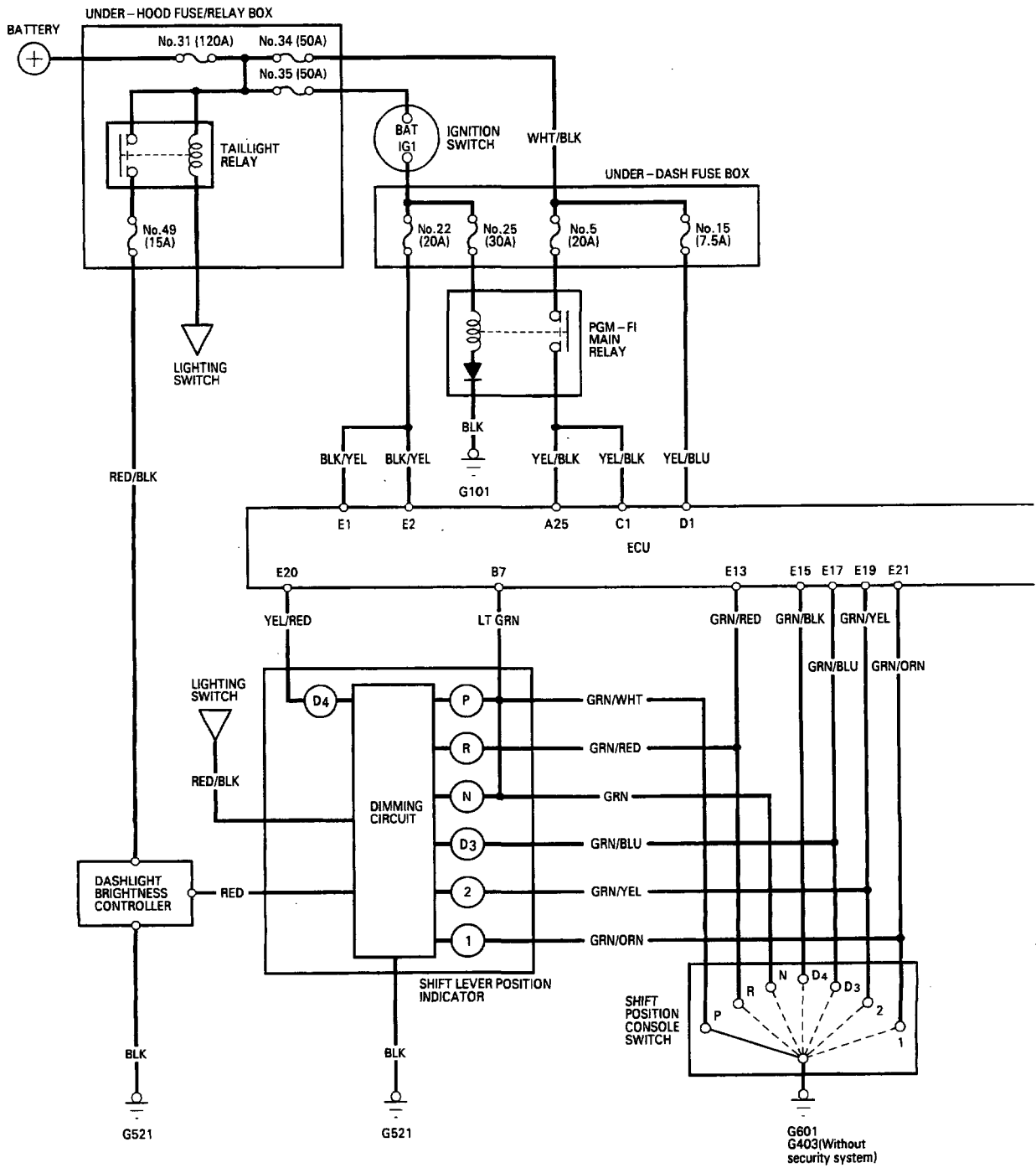



Terminal Location

A1	A2	A3	A4	A5	A6	A7	A8	A9	A10	A11	A12	A13	A14	A15	A16	A17	A18	A19	A20	A21	A22	A23	A24	A25	B1	B2	B3	B4	B5	B6	B7	B8	B9	B10	B11	B12	B13	B14	B15	C1	C2	C3	C4	C5	C6	C7	C8	C9	C10	C11	D1	D2	D3	D4	D5	D6	D7	D8	D9	D10	D11	D12	D13	D14	D15	D16	D17	D18	D19	D20	D21	D22	E1	E2	E3	E4	E5	E6	E7	E8	E9	E10	E11	E12	E13	E14	E15	E16	E17	E18	E19	E20	E21	E22	E23	E24	E25
A2	A4	A8	A8	A10	A10	A12	A14	A14	A16	A16	A20	A22	A24	A26	B2	B4	B6	B8	B10	B12	B14	B16	C2	C4	D2	D4	D6	D12	D14	D16	D20	D22	E2	E4	E6	E8	E10	E12	E14	E16	E18	E20	E24	E26																																																					

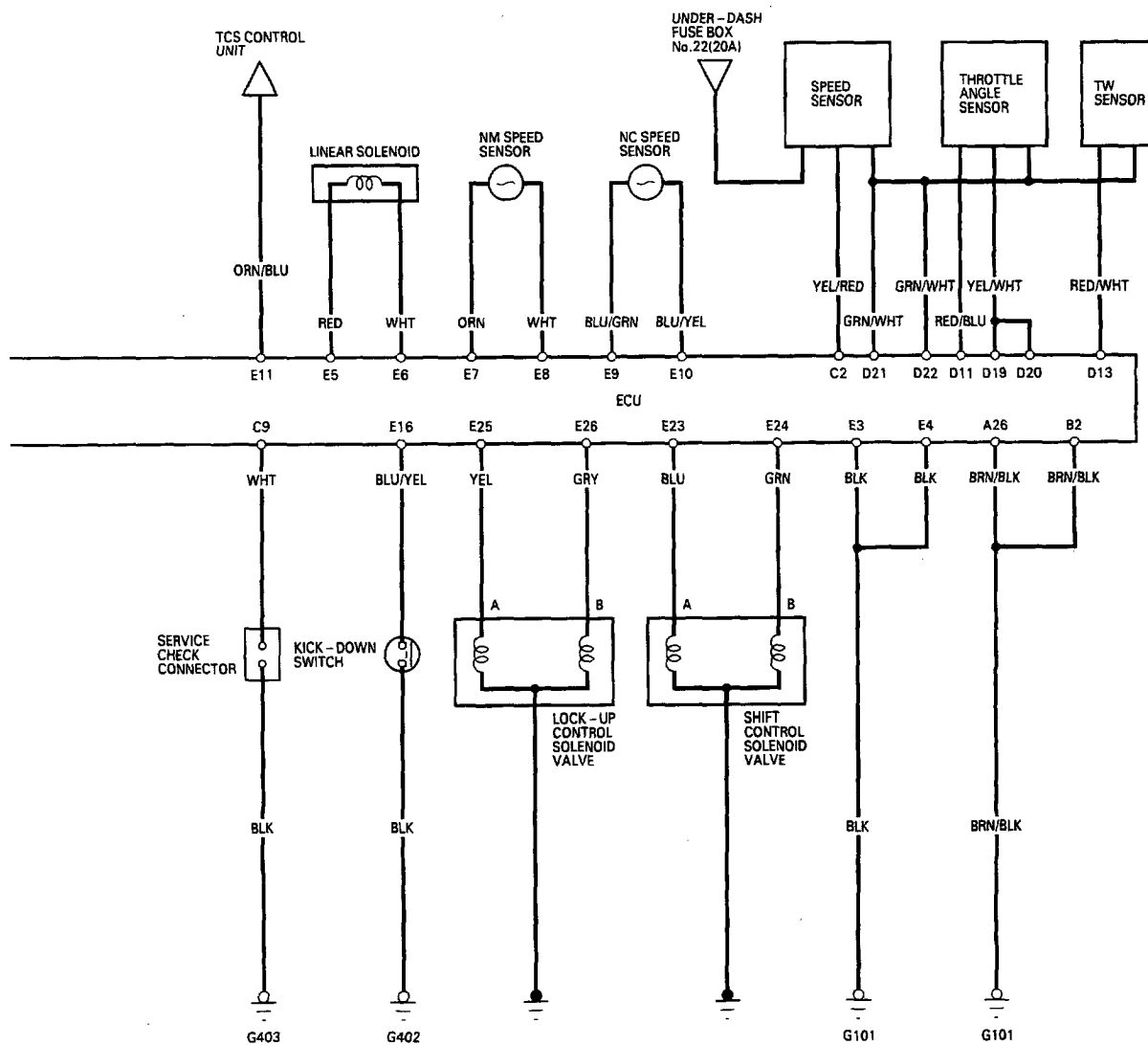

Circuit Diagram

RHD:

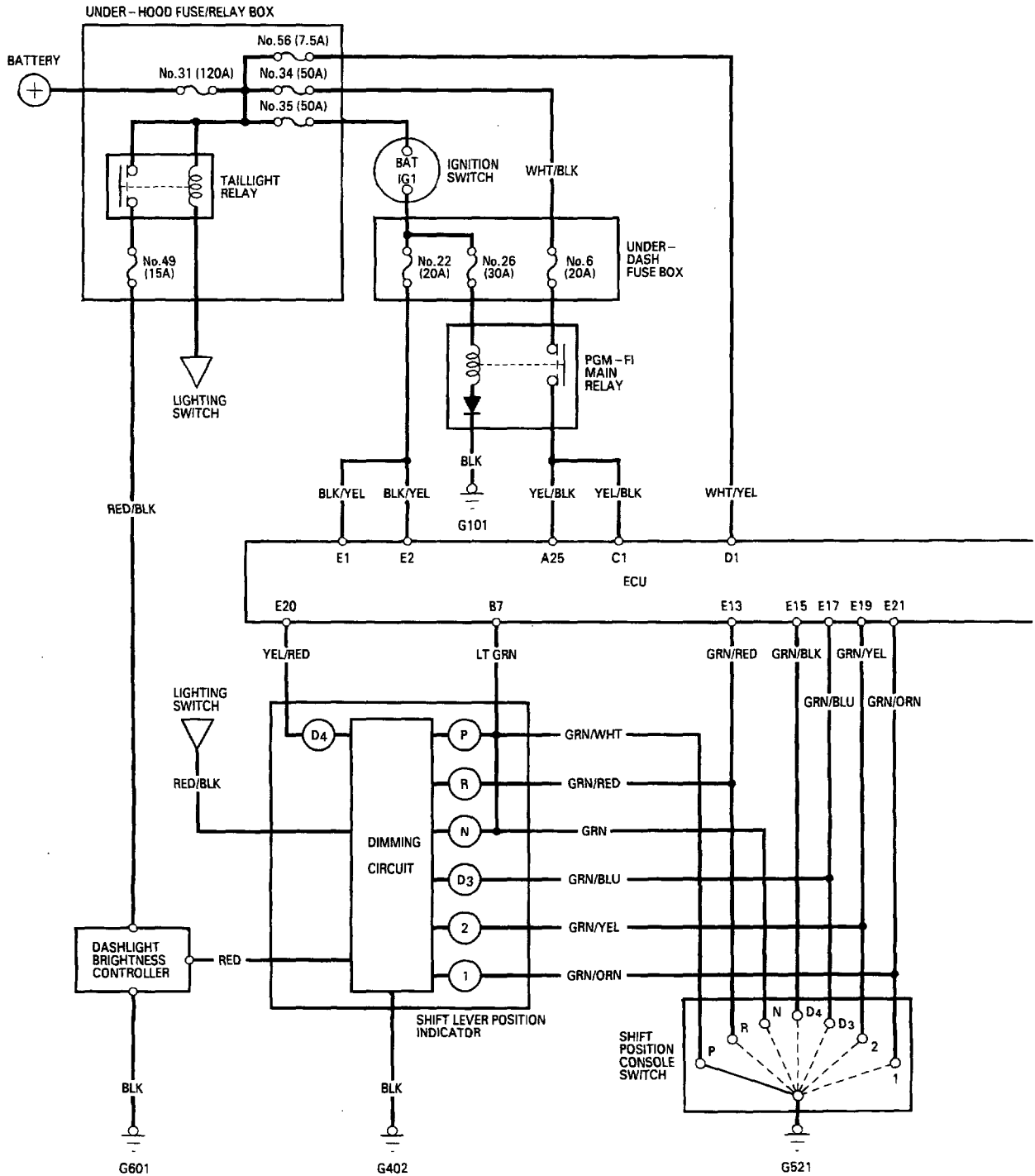



Terminal Location

