

164400

Removal and Replacement

* **Note:** The procedure given is for the left hand ram only. The procedure for the right hand ram is similar but to avoid damage, the position control sensor must be removed first (see **Position Sensor Removal and Replacement**).

Removal

- 1 Ensure that lift rams are fully closed as pressure cannot be vented by operating controls with engine stopped.
- 2 Remove left hand rear wheel.
- 3 Slacken the five bolts **A**.

Note: This may not always be necessary as it is only required to release any loading on pin **F**.

- 4 Lower the pick-up hitch to the ground.
- 5 Remove pin **B** and lower the left hand lower link and lift rod to the ground.
- 6 Disconnect and blank the hydraulic connection **C**.
- 7 Remove circlip **D**, washer **E** and drive out the bottom pin **F** as far as necessary to release the ram.
- 8 Support the ram, remove circlip **G**, washer **H** and drive out top pin **J**.

Replacement

Reverse the removal procedure.

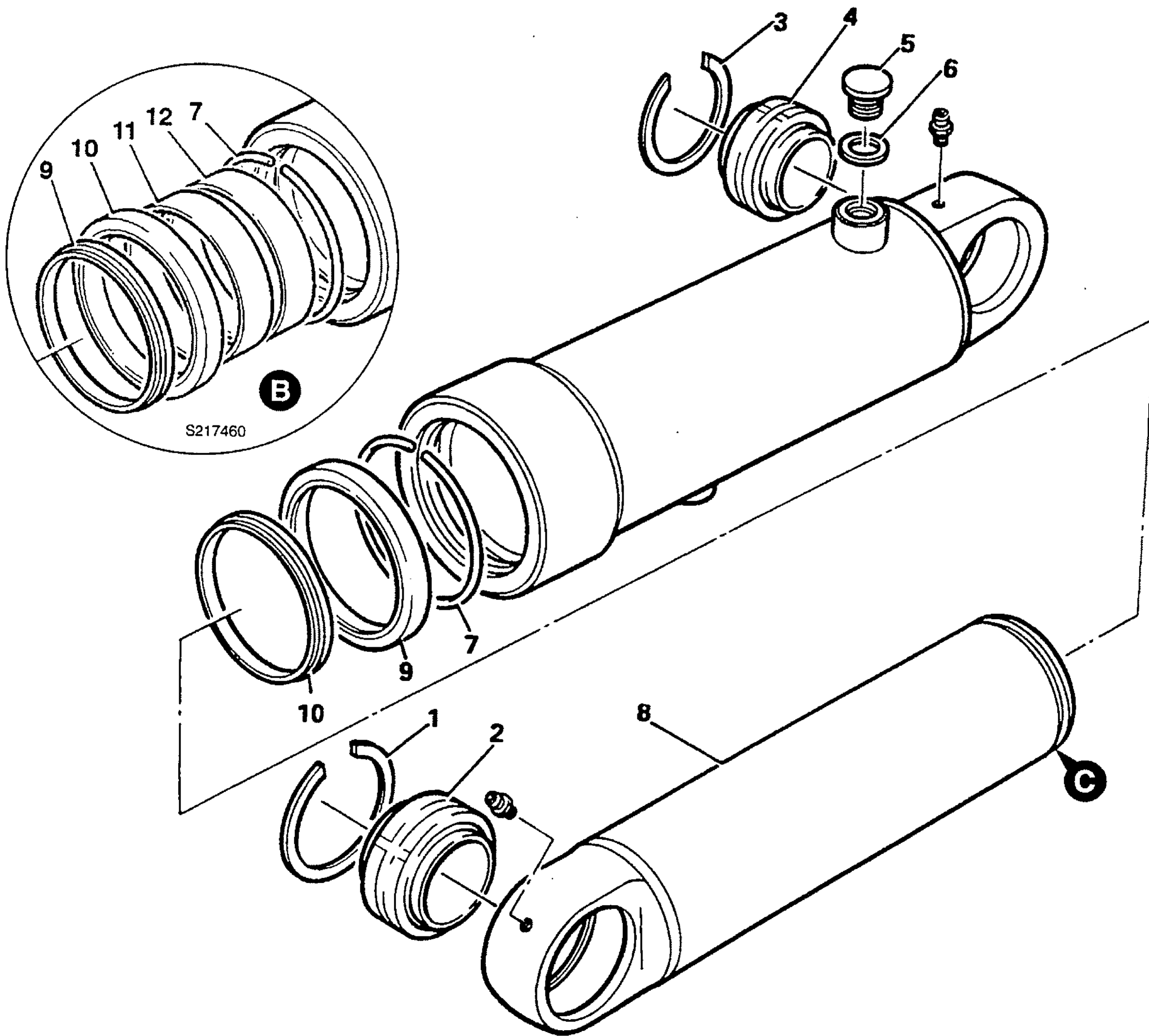
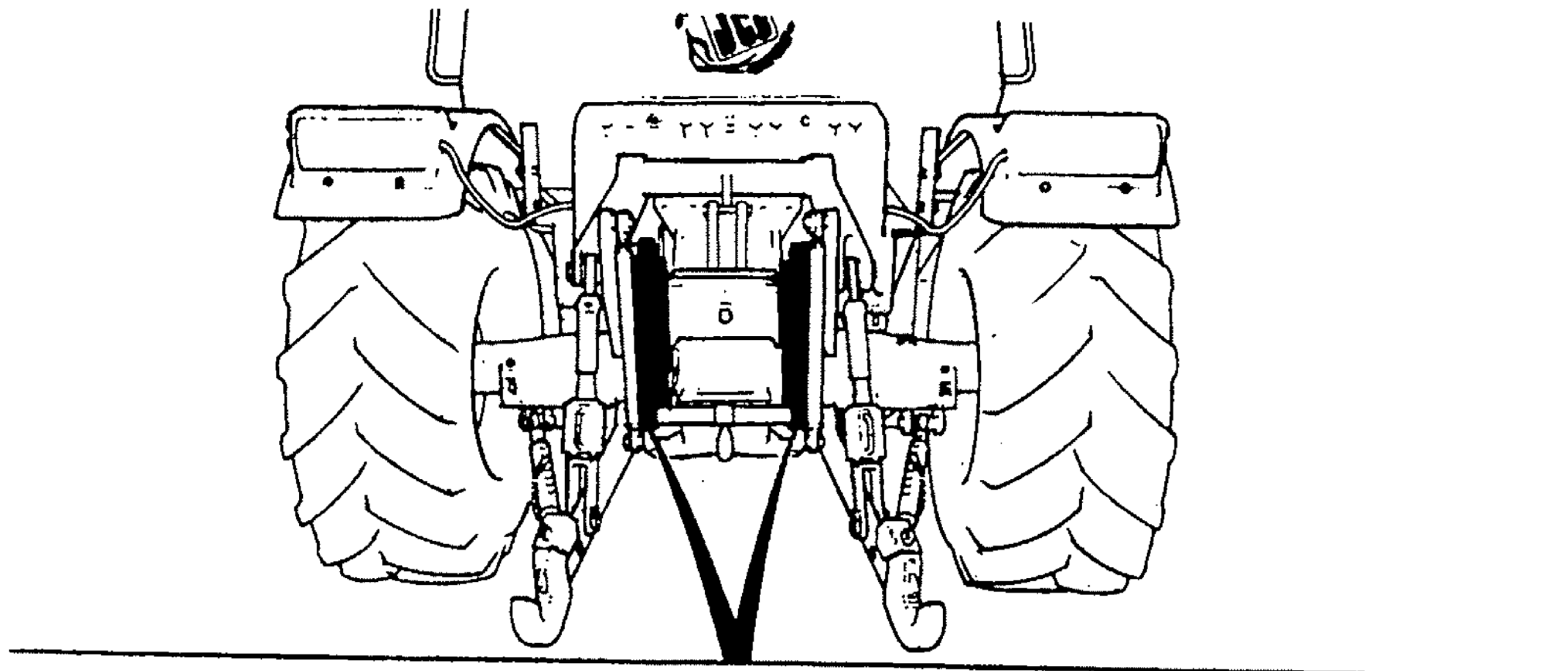

162030