

## Cylinder - Remove lift arm cylinder

L213, L215, C227

### **⚠ WARNING**

#### **Heavy objects!**

Lift and handle all heavy components using lifting equipment with adequate capacity. Always support units or parts with suitable slings or hooks. Make sure the work area is clear of all bystanders. Failure to comply could result in death or serious injury.

W0398A

#### **Prior operation:**

**Tilt system - Tilt To secure the lift arm in the raised position on radial lift machines. (E.34.A)**

1. Label and disconnect cylinder hoses (1) and cap open ports

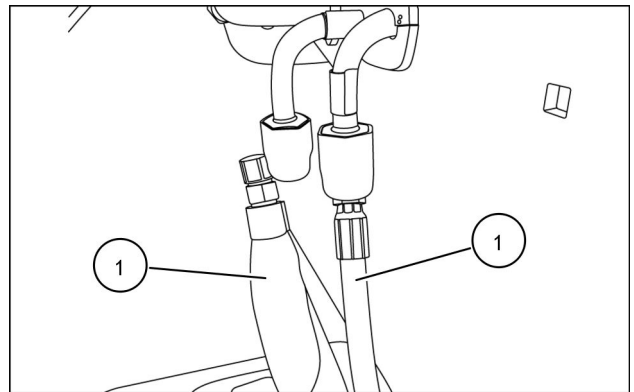

931001628 1

2. Remove lift cylinder rod end snap rings (1) from boom arm.

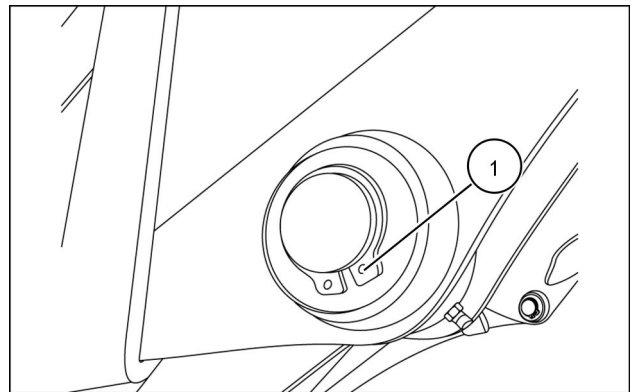

931001621 2

3. Remove rod end pins and washers (1).

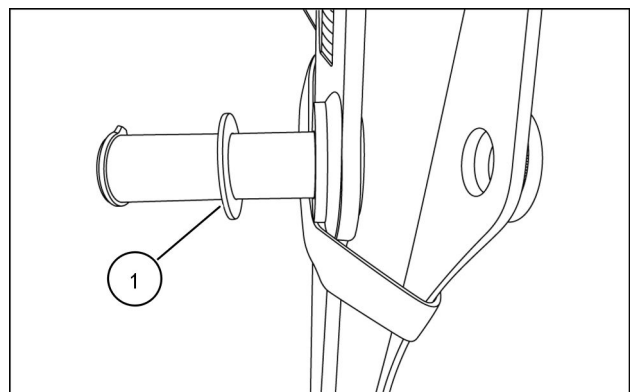

931001616 3

4. Lower cylinders (1) down.

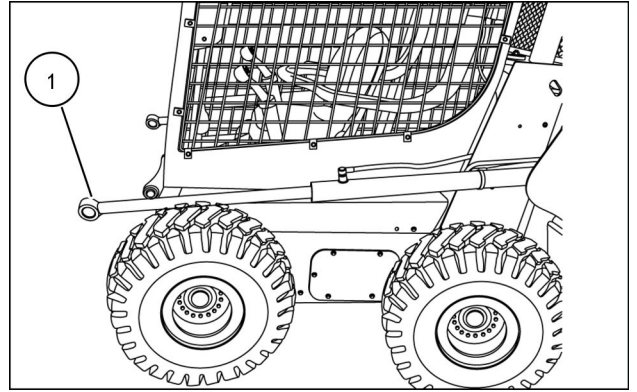

931001625 4

5. Remove lock nut (1) and pin retaining bolt (2) on both sides of the lift arm.

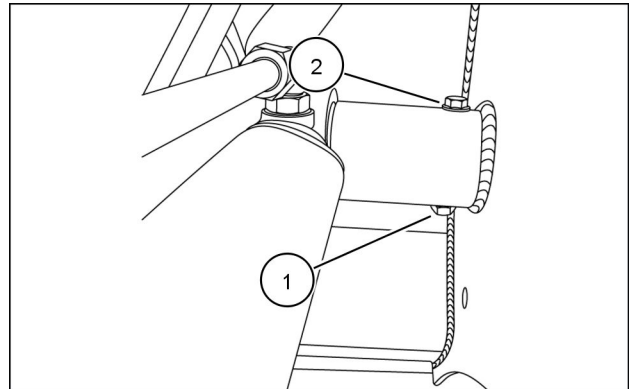

931001629 5

6. Remove rod end pins and washers from both sides of the lift arm.

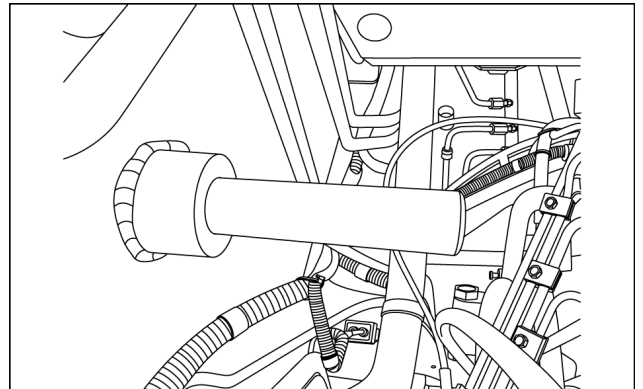

931001630 6

7. Remove cylinders

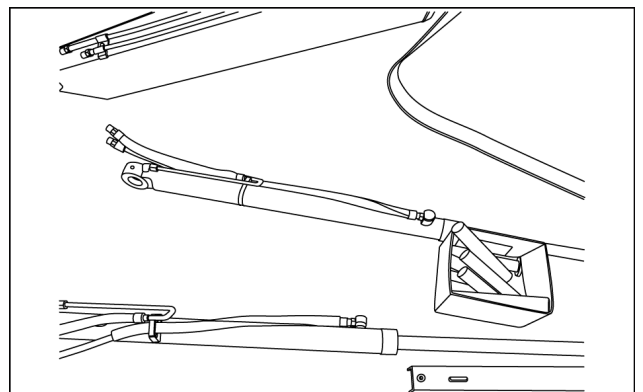

931001632 7

**Next operation:**  
**Cylinder - Install lift arm cylinder (H.20.B)**

## Cylinder - Install lift arm cylinder

L230, C227

### **⚠ WARNING**

#### **Heavy objects!**

**Lift and handle all heavy components using lifting equipment with adequate capacity. Always support units or parts with suitable slings or hooks. Make sure the work area is clear of all bystanders. Failure to comply could result in death or serious injury.**

W0398A

#### **Prior operation:**

#### **Cylinder - Remove lift arm cylinder (H.40.B)**

1. Lubricate the rod end pins, **(1)**, with **LOCTITE® 767 ANTI-SEIZE** lubricant.
2. Install the cylinder onto the skid steer.

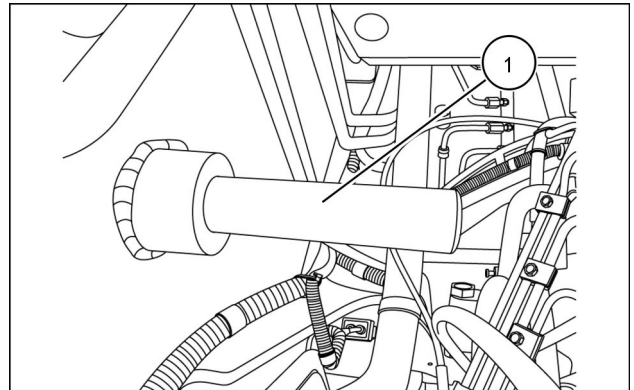

931001630 1

3. Install pin retaining bolt **(1)**, and locknut, **(2)**.
4. Torque the upper pivot pin hardware to **38 Nm ( 28 lb ft)**.

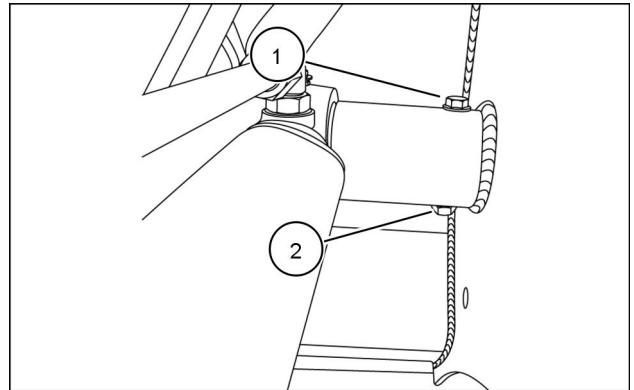

931001629 2

5. Install the rod end pins and washers **(1)** through the lift arms and cylinder end.

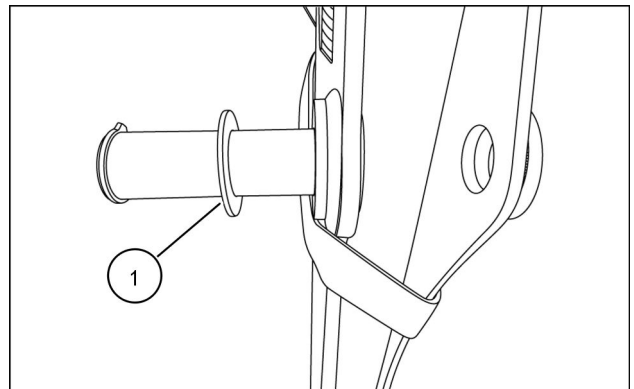

931001616 3

6. Install rod end snap rings (1).

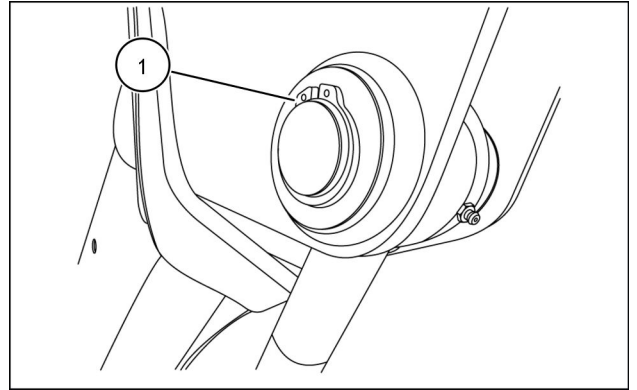

931001618 4

7. Install the hydraulic cylinder hoses (1), and position to prevent contact with other components, fenders, etc. Tighten hose fittings to standard torque.
8. Lower the lift arm. **Tilt system - Tilt To secure the lift arm in the raised position on radial lift machines. (E.34.A)**
9. Start the skid steer and cycle the boom several times to remove trapped air from the system and check the cylinder for leaks.

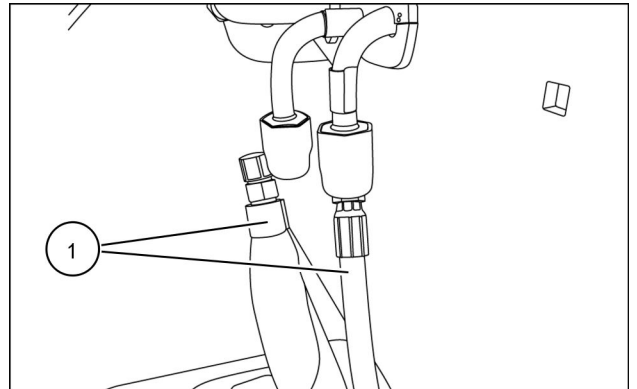

931001628 5

## Cylinder - Remove lift arm cylinder

L218, L220, L223, L225, L230, C232, C238

### **⚠ WARNING**

#### **Heavy objects!**

**Lift and handle all heavy components using lifting equipment with adequate capacity. Always support units or parts with suitable slings or hooks. Make sure the work area is clear of all bystanders. Failure to comply could result in death or serious injury.**

W0398A

1. Label and disconnect cylinder hoses (1) and cap open ports

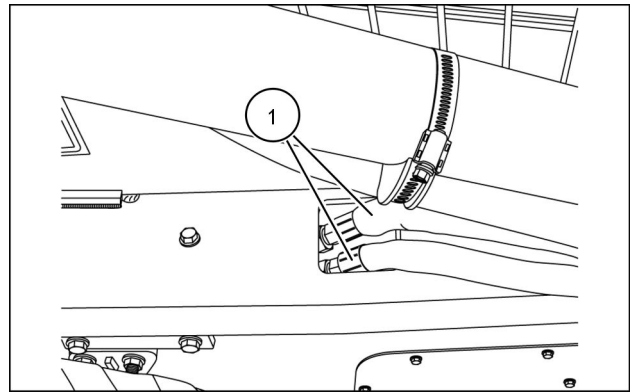

93112872 1

2. Remove lift cylinder rod end pin (2) and retaining bolt (1) and nut (3) from boom arm.

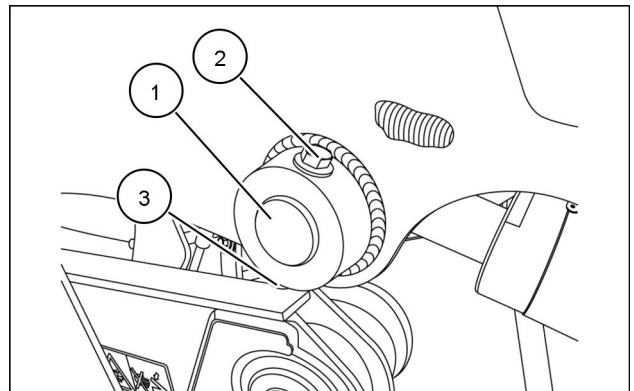

93112873 2

3. Remove rod end pins and washers (1).

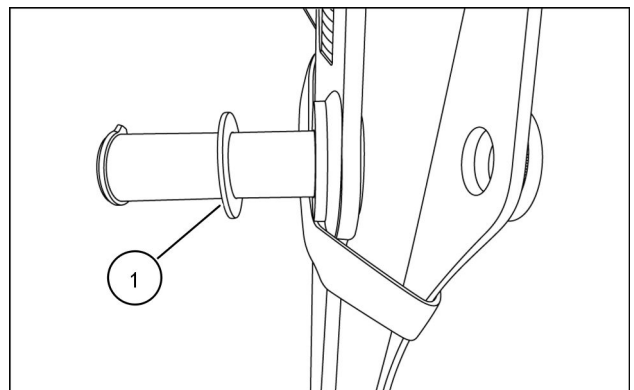

931001616 3

4. Lower cylinders (1) down.

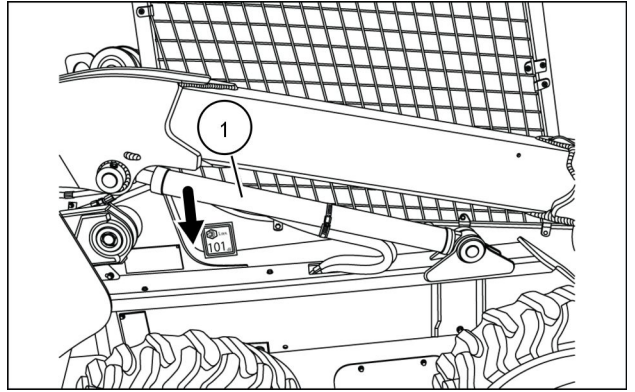

93112875 4

5. Remove lock nut (1) and pin retaining bolt (2) on frame.

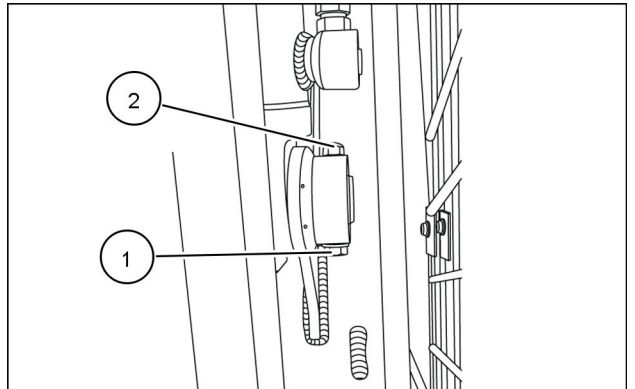

93112874 5

6. Remove rod end pins and washers from both sides of the frame.

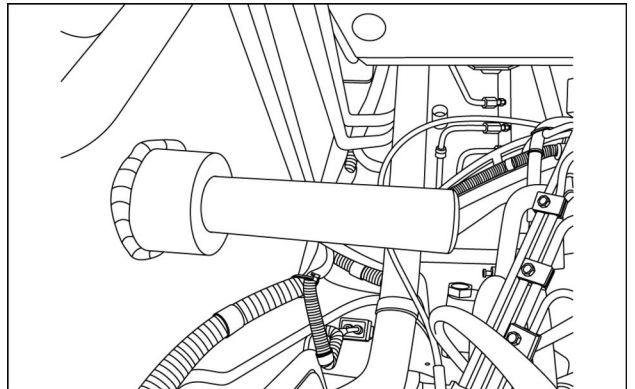

931001630 6

7. Remove cylinders

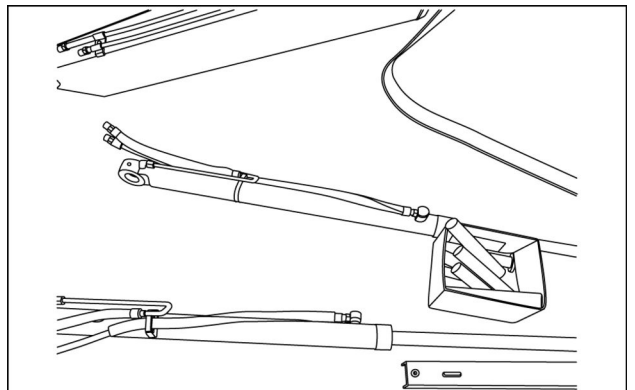

931001632 7

**Next operation:**  
**Cylinder - Install lift arm cylinder (H.40.B)**