

Lower shoe - Install (Smart Sieve™)

CSX7060, CSX7080, CSX7060 Laterale, CSX7080 Laterale, CSX7040, CSX7050, CSX7050 Laterale, CSX7070

1. Insert the lower shaker shoe and support it well.

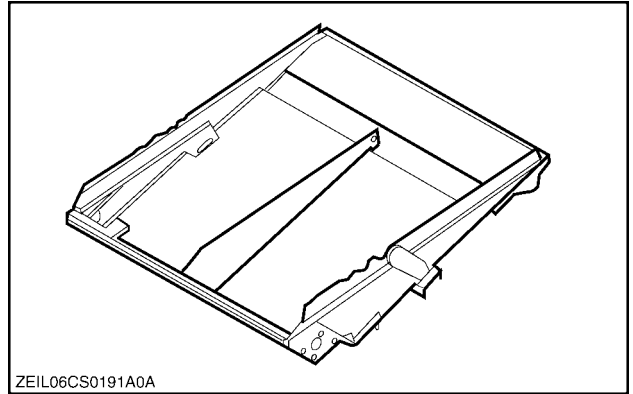

ZEIL06CS0191A0A 1

- 2.
- Install the support plates (78) with the bolt connections (77).
 - Install the arms (75) with the joint components (76) and secure them with the bolts, the lock washers and the lock nuts (74) and with the lock washers and the bolts (73). Do not tighten completely. (See fig. 7)

NOTE: Install the bolts (73) with a thread locking compound. (**LOCTITE® 242**, **OMNIFIT 50M** or **PERMABOND 113**)

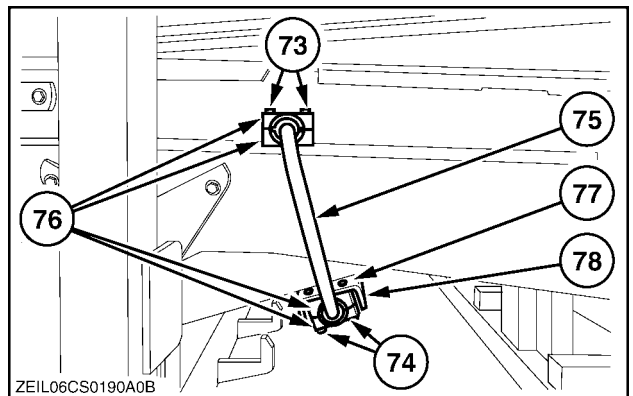

ZEIL06CS0190A0B 2

NOTE: Install the joint components (76) onto the arms (75) and (86) with the reinforcement rib turned to the side of the arms. See arrow.

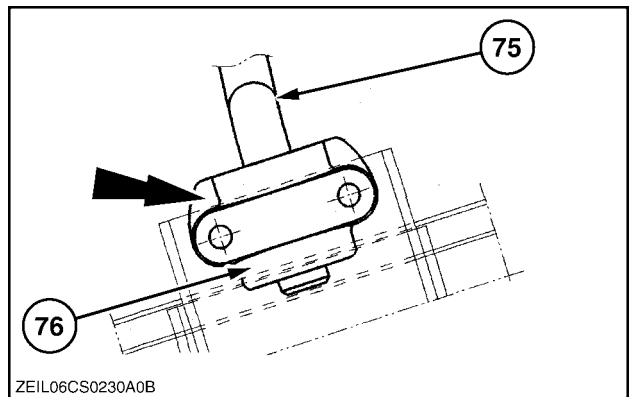

ZEIL06CS0230A0B 3

3. Install the plates (72), the hinge plates (71) and (85) with the lock washers and the bolts (70).

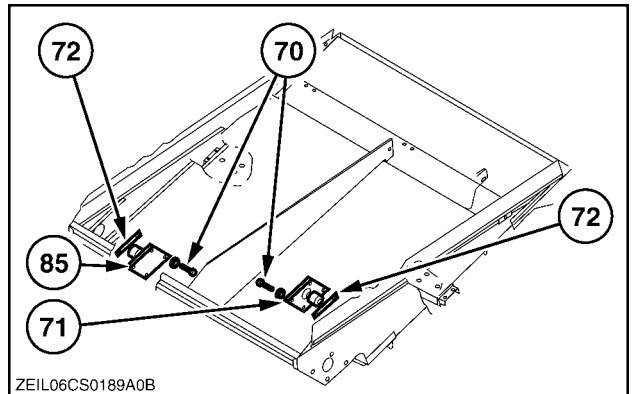

ZEIL06CS0189A0B 4

4. On the left hand side:
Install the hinge joint halves (69) with the bolts, the lock washers and the lock nuts (68). Do not tighten the bolts completely.

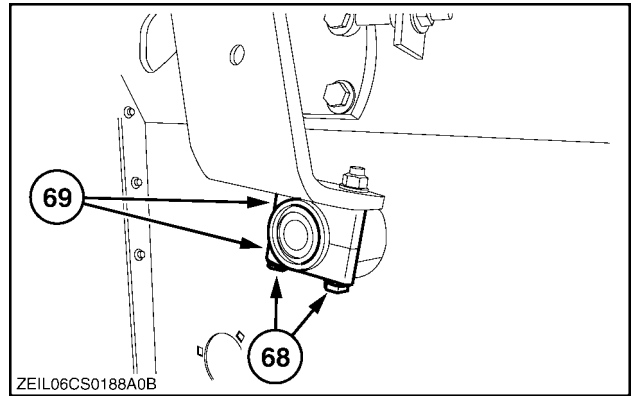

ZEIL06CS0188A0B 5

5. On the right hand side:
Install the hinge joint halves (69) with the bolts, the lock washers and the lock nuts (68). Do not tighten the bolts completely.

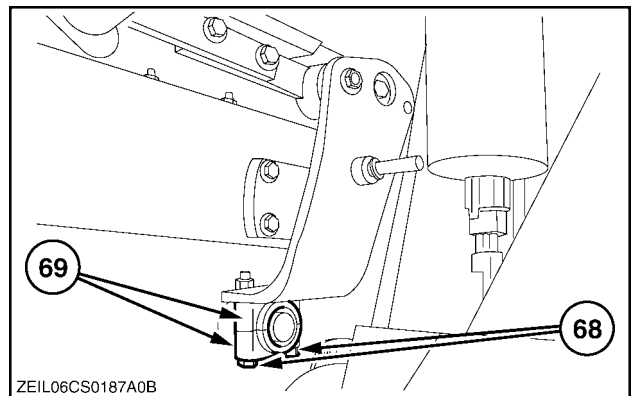

ZEIL06CS0187A0B 6

6. On both sides:
- Check that the lower shaker shoe is in the middle of the combine frame **MAXIMUM ALLOWED DEVIATION = +/- 3 mm (15/128 in)**.
 - Connect the drive rods (46) and (47) Refer to **Shoe drive system Shaft - Install (K.62.B)**.

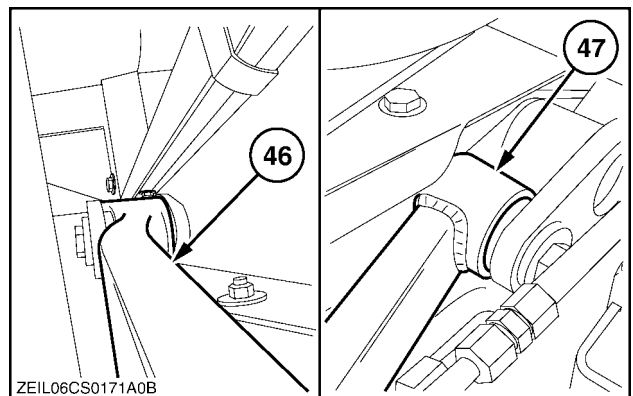

ZEIL06CS0171A0B 7

- 7.
- Check that the shaker shoes are in their mid stroke position, refer to **Upper sieve levelling system Motor - Install (K.62.B)**.
 - Make sure there is no tension on the rubber blocks. Tighten all bolt connections firmly.

NOTE: Always tighten the bolts in the round holes first and then the bolts in the slotted holes.

Next operation:

Upper shoe - Install (K.62.B).

Next operation:

Linkage install

Next operation:

Upper sieve levelling system Motor - Install (K.62.B).

Index

CROP PROCESSING - K

CLEANING Primary cleaning - 62.B

CLEANING Primary cleaning - Static description	4
Fan Deflector - Adjust	70
Fan Housing - Install	65
Fan Housing - Remove	59
Fan Shaft - Install	56
Fan Shaft - Remove	53
Fan variator Belt - Install	75
Fan variator Belt - Remove	72
Fan variator Driven disc - Assemble	80
Fan variator Driven disc - Disassemble	79
Fan variator Driven disc - Install	81
Fan variator Driven disc - Remove	78
Grain pan - Install	84
Grain pan - Remove	82
Lower shoe - Install (Smart Sieve™)	91
CSX7060, CSX7080, CSX7060 Laterale, CSX7080 Laterale, CSX7040, CSX7050, CSX7050 Laterale, CSX7070	
Lower shoe - Remove (Smart Sieve™)	89
CSX7060, CSX7080, CSX7060 Laterale, CSX7080 Laterale, CSX7040, CSX7050, CSX7050 Laterale, CSX7070	
Shoe drive system - Exploded view	5
Shoe drive system - Exploded view	8
Shoe drive system - Sectional view	6
Shoe drive system - Sectional view	10
Shoe drive system Belt - Install	21
Shoe drive system Belt - Remove	20
Shoe drive system Shaft - Install	16
Shoe drive system Shaft - Remove	12
Upper shoe - Install	29
Upper shoe - Install (Smart Sieve™)	40
CSX7060, CSX7080, CSX7060 Laterale, CSX7080 Laterale, CSX7040, CSX7050, CSX7050 Laterale, CSX7070	
Upper shoe - Remove	22
Upper shoe - Remove (Smart Sieve™)	35
CSX7060, CSX7080, CSX7060 Laterale, CSX7080 Laterale, CSX7040, CSX7050, CSX7050 Laterale, CSX7070	
Upper shoe Arm - Assemble	52
CSX7060, CSX7080, CSX7060 Laterale, CSX7080 Laterale, CSX7040, CSX7050, CSX7050 Laterale, CSX7070	
Upper shoe Arm - Install (Smart Sieve™)	45
CSX7060, CSX7080, CSX7060 Laterale, CSX7080 Laterale, CSX7040, CSX7050, CSX7050 Laterale, CSX7070	
Upper shoe Arm - Install (Smart Sieve™)	50
CSX7060, CSX7080, CSX7060 Laterale, CSX7080 Laterale, CSX7040, CSX7050, CSX7050 Laterale, CSX7070	
Upper shoe Arm - Remove (Smart Sieve™)	44
CSX7060, CSX7080, CSX7060 Laterale, CSX7080 Laterale, CSX7040, CSX7050, CSX7050 Laterale, CSX7070	
Upper shoe Arm - Remove (Smart Sieve™)	47
CSX7060, CSX7080, CSX7060 Laterale, CSX7080 Laterale, CSX7040, CSX7050, CSX7050 Laterale, CSX7070	
Upper sieve levelling system Motor - Exploded view	11
CSX7060, CSX7080, CSX7060 Laterale, CSX7080 Laterale, CSX7040, CSX7050, CSX7050 Laterale, CSX7070	

Upper sieve levelling system Motor - Install (Smart Sieve™) 87
CSX7060, CSX7080, CSX7060 Laterale, CSX7080 Laterale, CSX7040, CSX7050, CSX7050 Laterale, CSX7070
Upper sieve levelling system Motor - Remove (Smart Sieve™) 85
CSX7060, CSX7080, CSX7060 Laterale, CSX7080 Laterale, CSX7040, CSX7050, CSX7050 Laterale, CSX7070



CROP PROCESSING - K

CLEANING Tailings return system - 62.C

CSX7000

Contents

CROP PROCESSING - K

CLEANING Tailings return system - 62.C

FUNCTIONAL DATA

Cross auger	
Exploded view	3

SERVICE

Cross auger	
Remove	4
Install	8

Return auger

Remove	12
Install	14

Tailings elevator

Chain - Remove	16
Chain - Install	18
Remove	20
Install	24

Cross auger - Exploded view

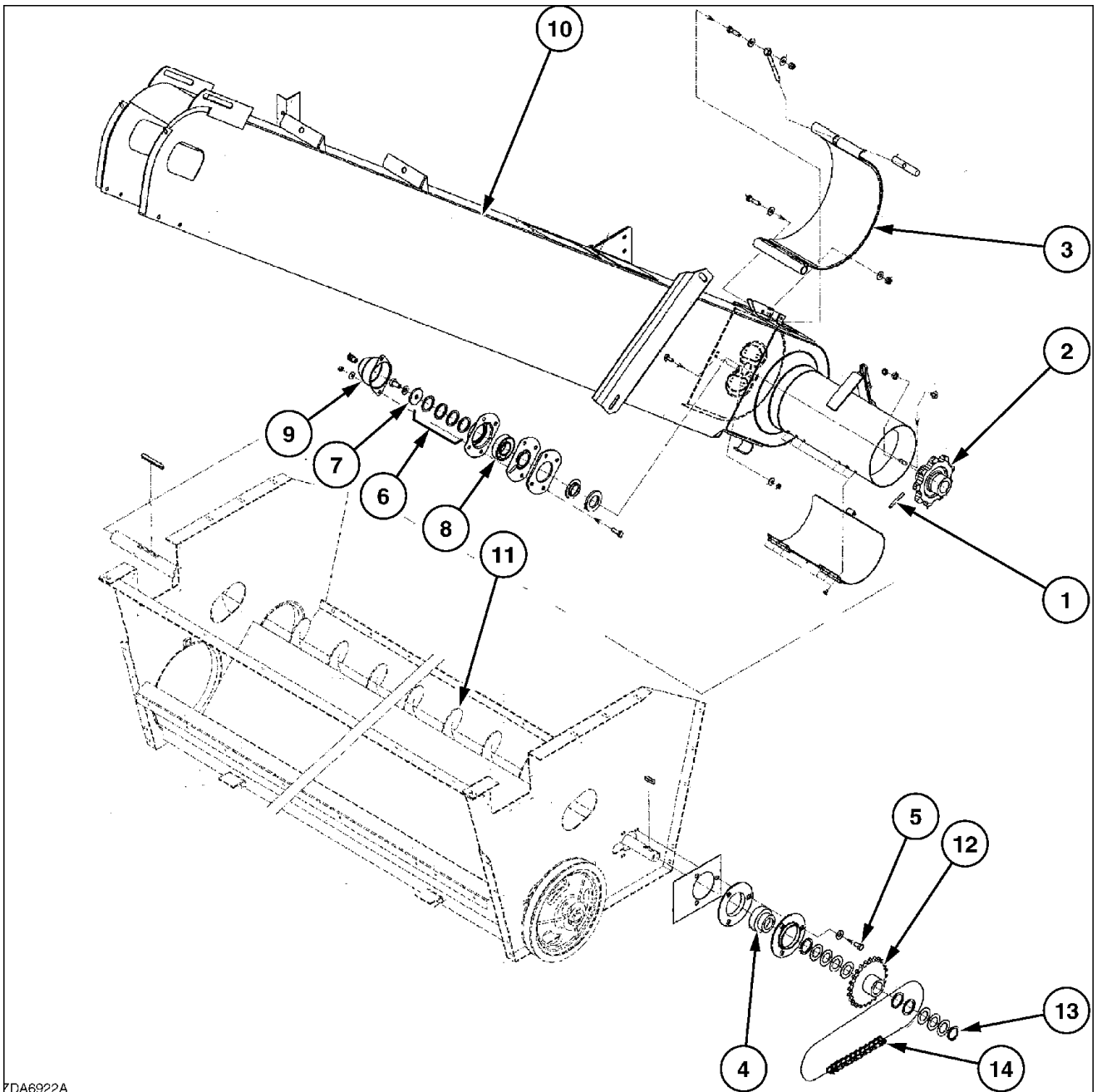

ZDA6922A

ZDA6922A 1

Cross auger

- | | |
|------------------------|---------------------|
| 1 Dowel pin | 2 Sprocket |
| 3 Cover | 4 Bearing |
| 5 Bolt | 6 Shims |
| 7 Washer | 8 Bearing |
| 9 Grease cover | 10 Returns elevator |
| 11 Returns cross auger | 12 Sprocket |
| 13 Retaining ring | 14 Drive chain |

Cross auger - Remove

1. At the left-hand side, loosen the nut **(2)** of the idler **(1)** and remove the cotter pins to open the coupler links of the chain.

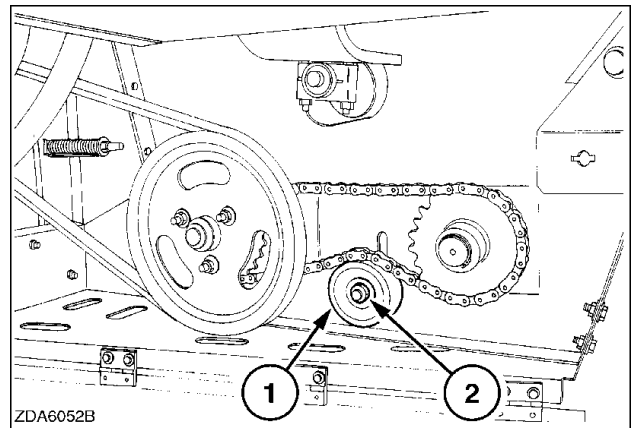

2. Remove the bolt **(4)** to open the cover **(3)**.

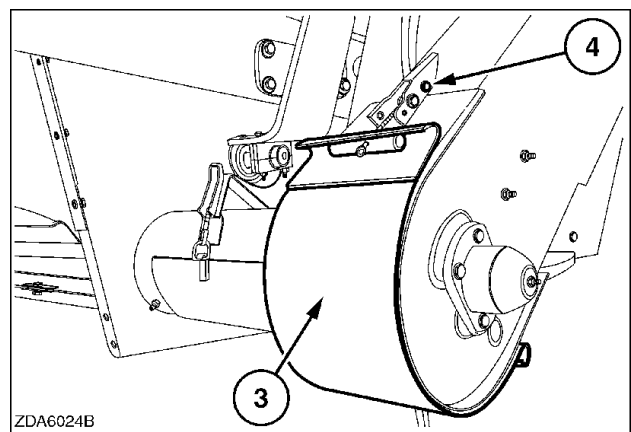

3. Rotate the elevator chain until the coupler links are accessible on the bottom sprocket.
4. Loosen the nut **(3)** to release the chain tension. If not, loosen also the locknut **(1)**.

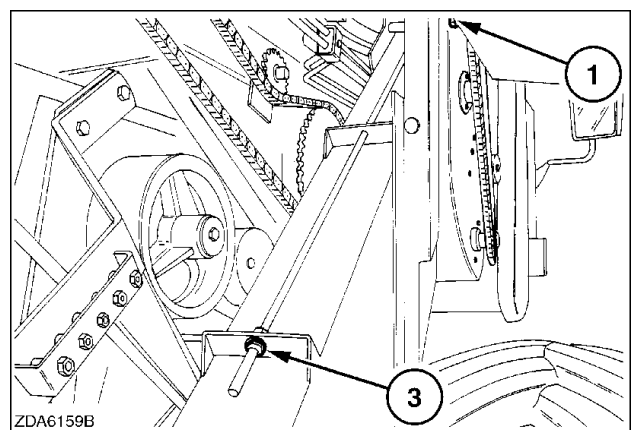

CROP PROCESSING - CLEANING Tailings return system

5. To open the chain, remove the cotter pin (1), to open the coupler links (2). To prevent from slipping out of the returns elevator chain, fit a rope on both ends of the chain.

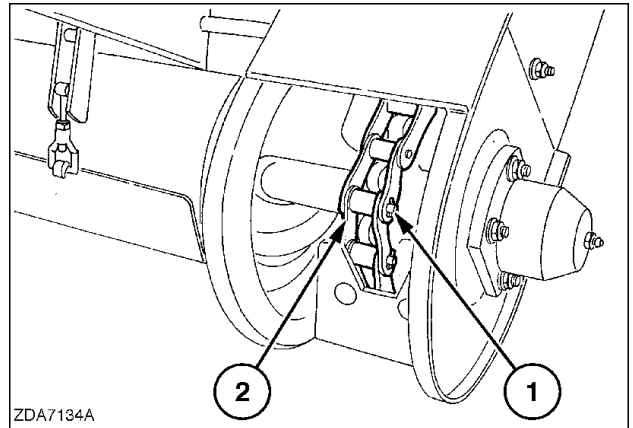

ZDA7134A 4

6. Remove the dowel pin (1) of the sprocket (2).

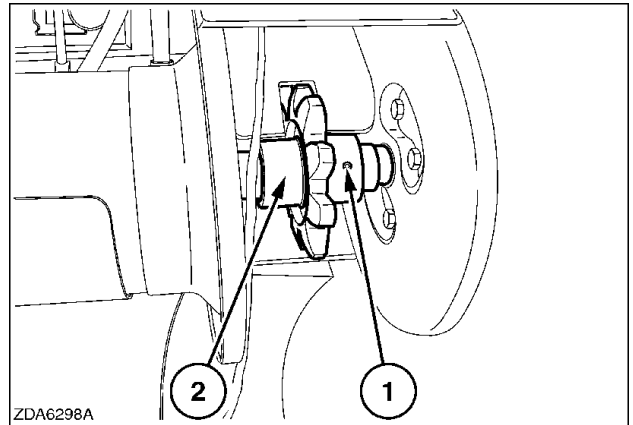

ZDA6298A 5

7. Remove the two nuts (3) and remove the cover (4).

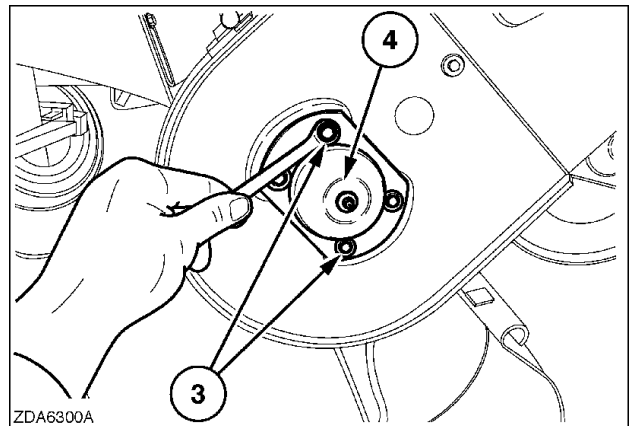

ZDA6300A 6

8. Remove the central bolt (5).
Remove two nuts (6).

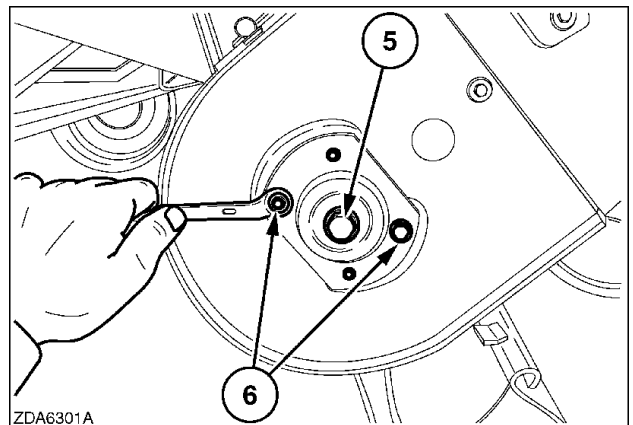

ZDA6301A 7

9. Remove the bearing flange (7), using a puller.

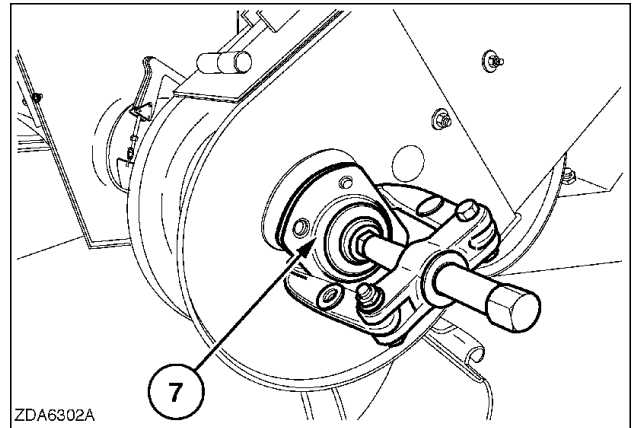

10. At the left-hand side, remove the retaining ring (1) and the washers.

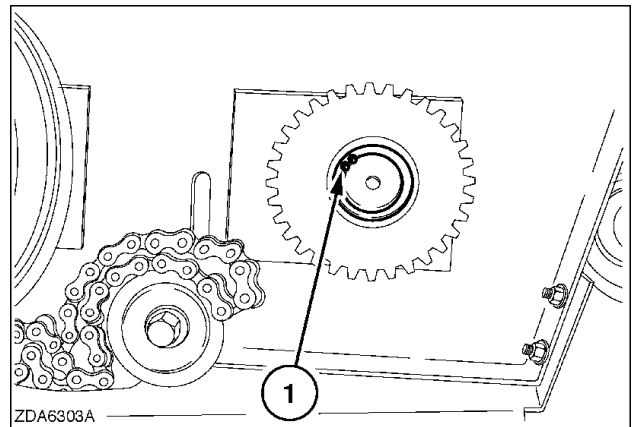

11. Remove the sprocket (2), using a puller.

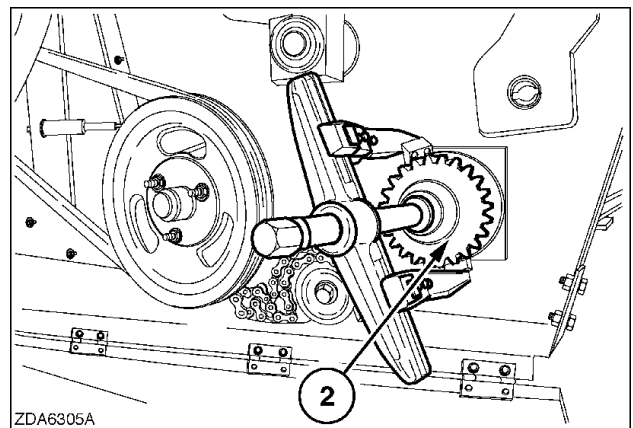

12. Remove the key (3) and loosen the lock collar (4). Loosen the three nuts (5).

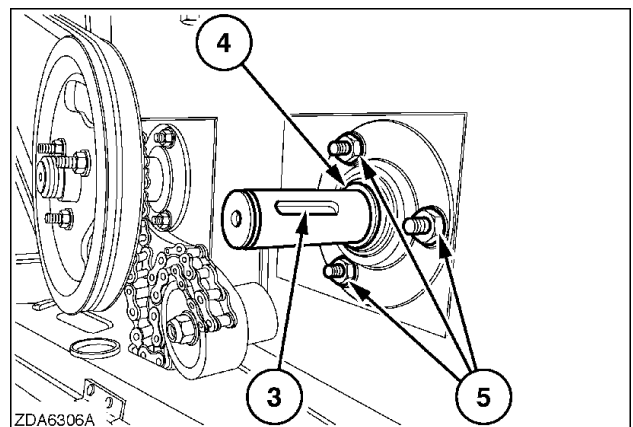

13. Turn out the auger through the long sleeve hole at the left-hand side.
At the right-hand side, remove the sprocket .

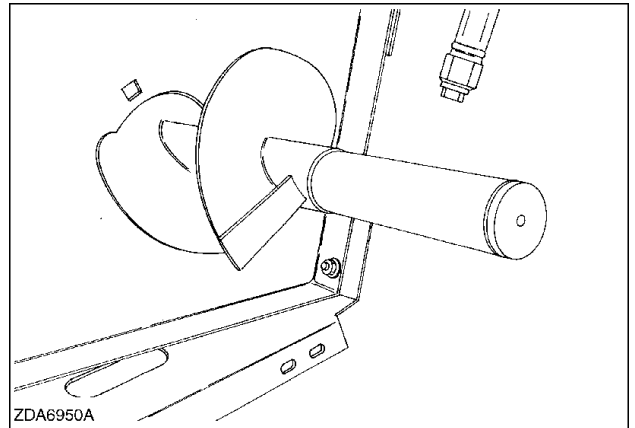

Cross auger - Install

1. Install the auger from the left-hand side by rotating the auger until it is completely in its auger housing.

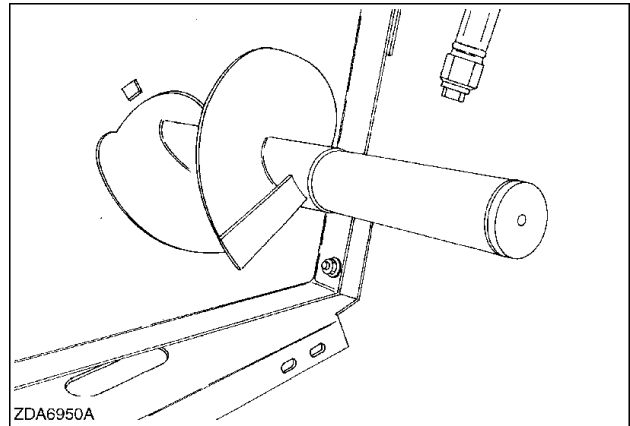

ZDA6950A

ZDA6950A 1

2. At the right-hand side, install sprocket (2) with the dowel pin (1).

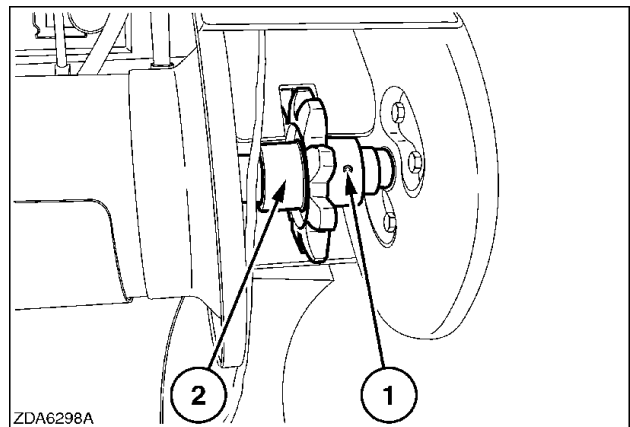

ZDA6298A

ZDA6298A_200 2

3. Install the left-hand side bearing (4) and tighten the nuts (5). (Do not install the lock collar).

NOTE: Grease the spherical outer ring with NLGI-2 and grease the inner ring of the bearing and the lock collar with anti-corrosive grease.

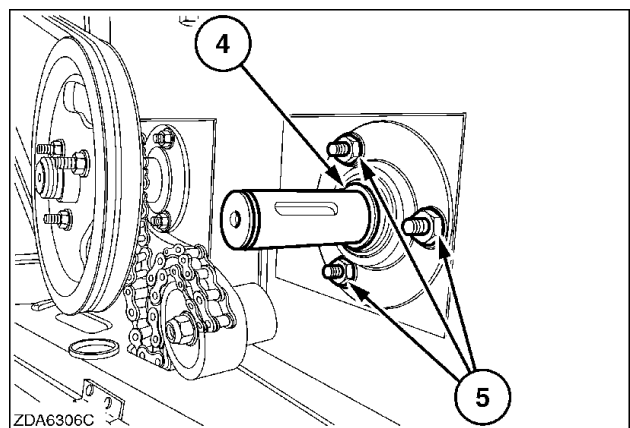

ZDA6306C

ZDA6306C 3

4. At the right-hand side, add shims (6) and the washer (7) until distance "X" = 65 mm. (2-9/16 in)
Tighten central bolt (5).

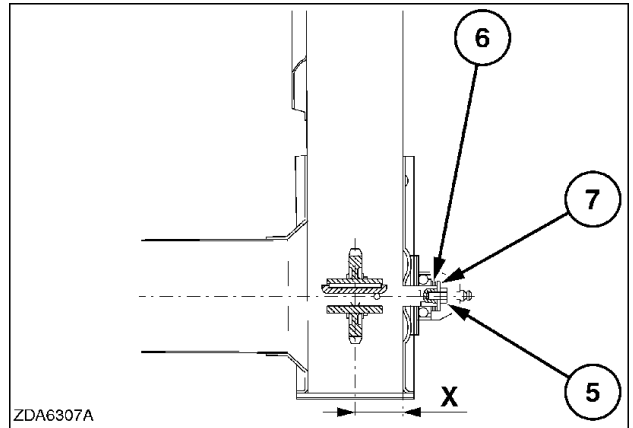

ZDA6307A 4

5. Install the cover (4) and tighten the nuts (3).

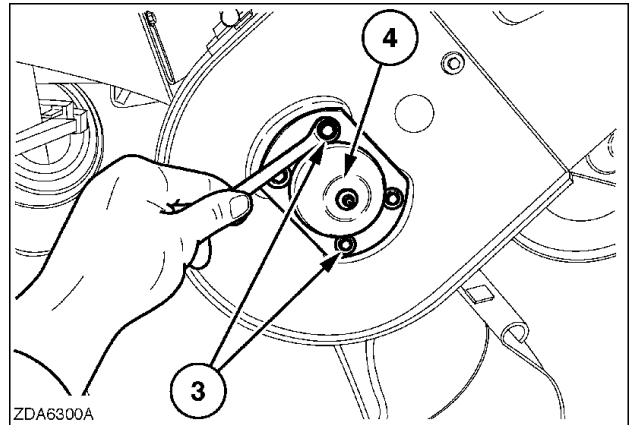

ZDA6300A 5

6. Close the returns elevator chain and install the cotter pins (1), to secure the coupler links (2).

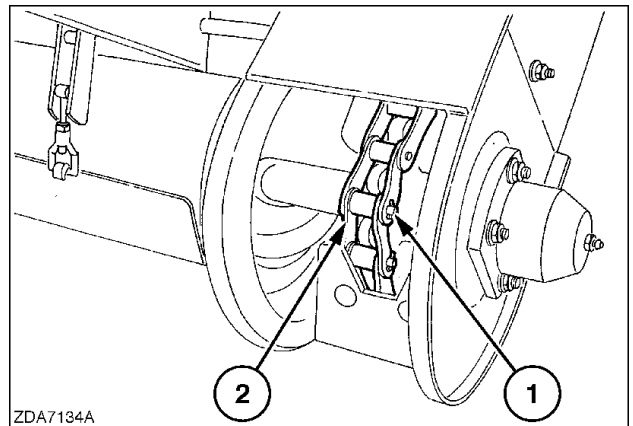

ZDA7134A 6

7. Insert the cotter pins in the direction of travel. (arrow)

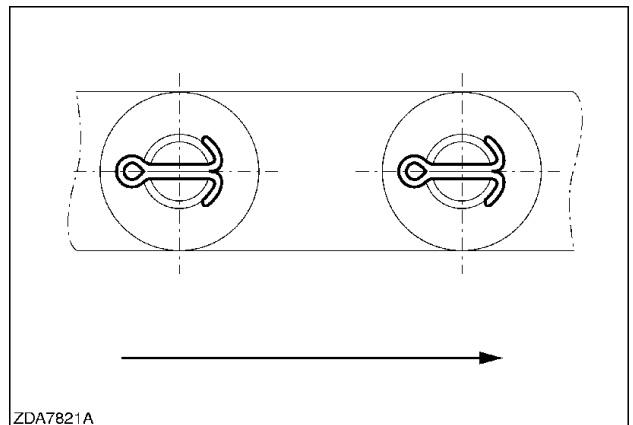

ZDA7821A 7

8. Adjust the tension of the chain with the nut (2) and (3).

NOTE: The tension of the returns elevator chain is correct when it is just possible to move a link laterally across the lower sprocket by hand.

NOTE: After adjusting the returns elevator chain, check the tension of the returns top auger drive chain (4).

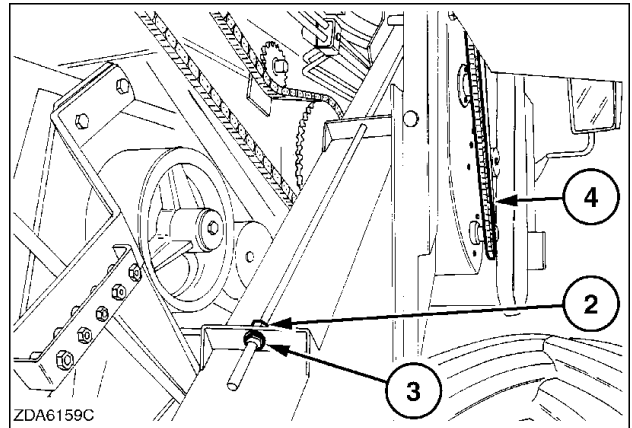

ZDA6159C 8

9. Close the bottom of the returns elevator with the cover (3) and secure it with the bolt (4).

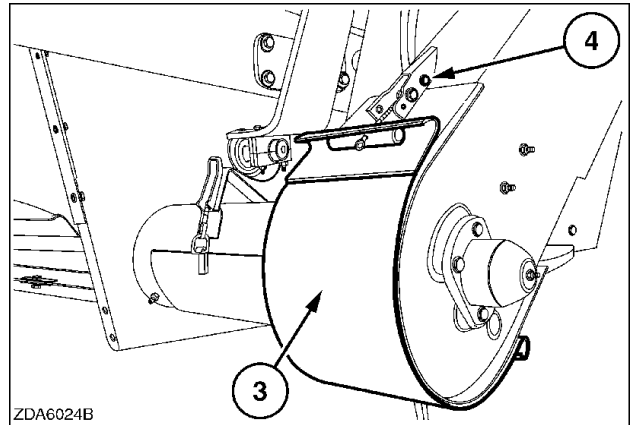

ZDA6024B 9

10. At the left-hand side, install the lock collar (4) and tighten the Allen screw.

NOTE: Grease the lock collar with anti-corrosive grease.

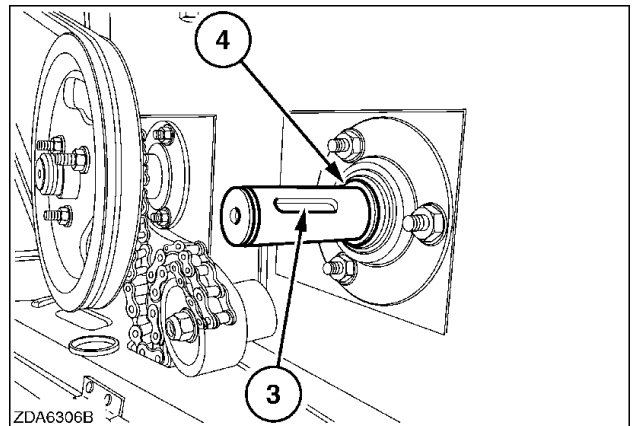

EDA6306B 10

11. Install the key (3).

12. Install the sprocket, the shims and the retaining ring (1).

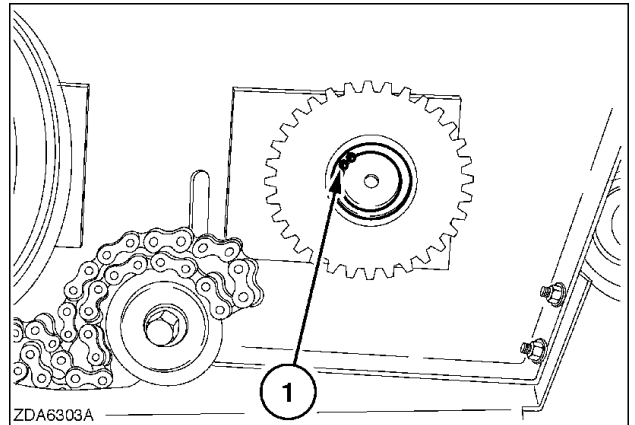

ZDA6303A 11

13. Install the chain with the coupler links and secure it with the cotter pins.

NOTE: Insert the cotter pins against the direction of travel.
(Refer to **Tailings elevator Chain - Install (K.62.C)**)

14. Adjust the chain with the idler (1) and tighten the nut (2).

NOTE: The chain tension is correct when it is just possible to move a link laterally across a sprocket by hand.

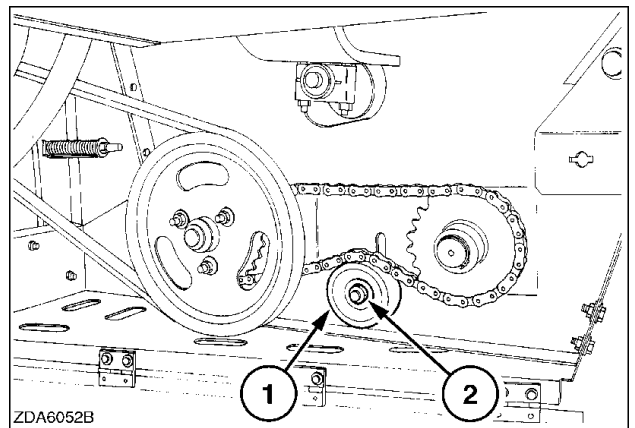

ZDA6052B 12

Return auger - Remove

1. At the right-hand side, open the top cover (6).

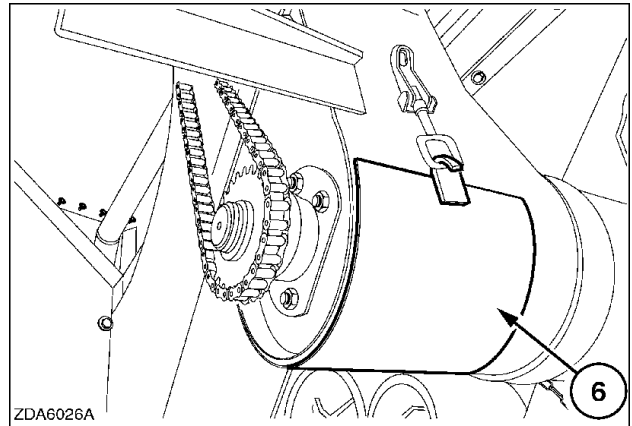

2. Loosen the nut (2), to move the idler (1). Remove the cotter pins to open the coupler links of the drive chain.

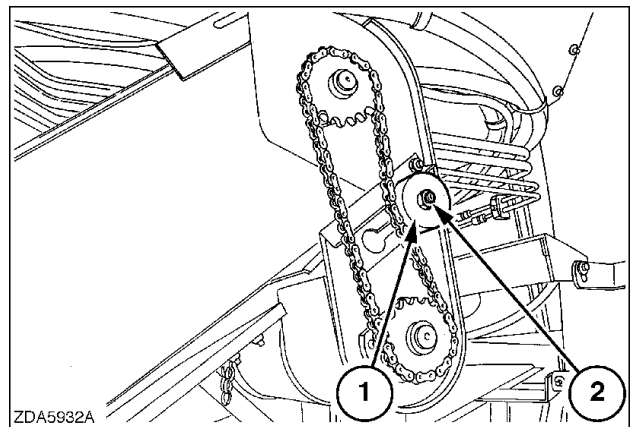

3. Remove the retaining ring (3), the washers and the sprocket (4). Remove the key.

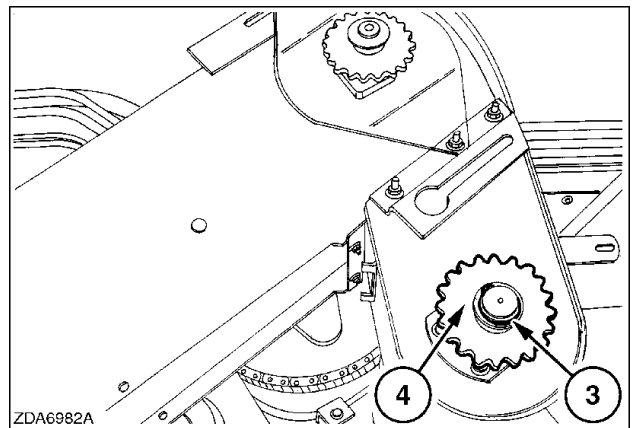

4. Remove the four nuts **(5)**.
Remove the bearing flange, using a puller.

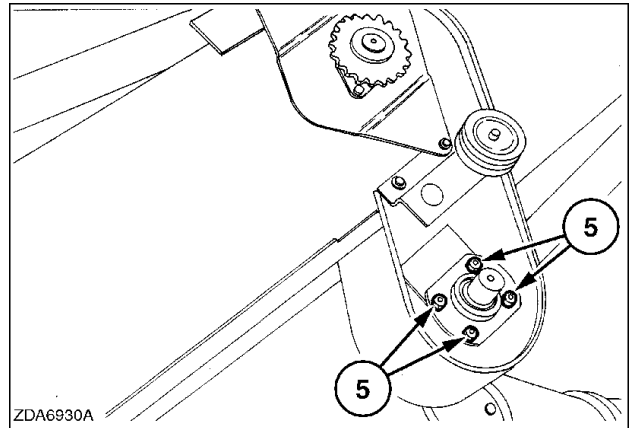

ZDA6930A 4

5. At the left-hand side, remove the two bolts **(1)** to remove the sensor support **(2)**.
Remove the central bolt **(3)** and remove the sensor plate **(4)**.

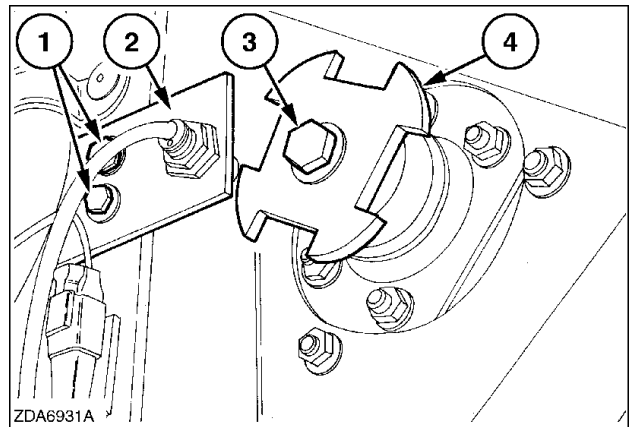

ZDA6931A 5

6. Loosen the Allen screw and remove the lock collar **(5)**.

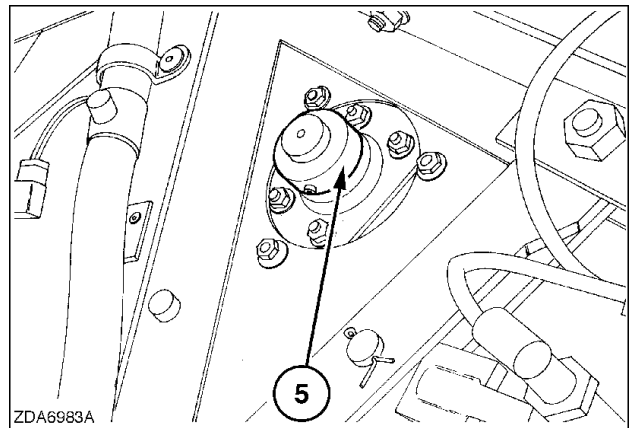

ZDA6983A 6

7. Push the shaft **(6)** out to the right-hand side, using a hammer.

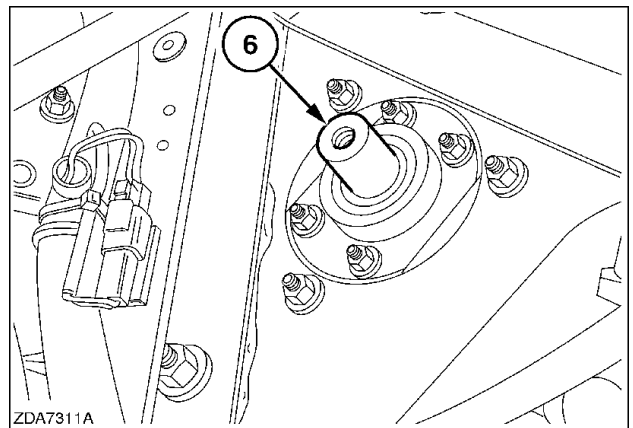

ZDA7311A 7

Return auger - Install

1. Bring the auger into his tube by turning the auger from the right-hand side.

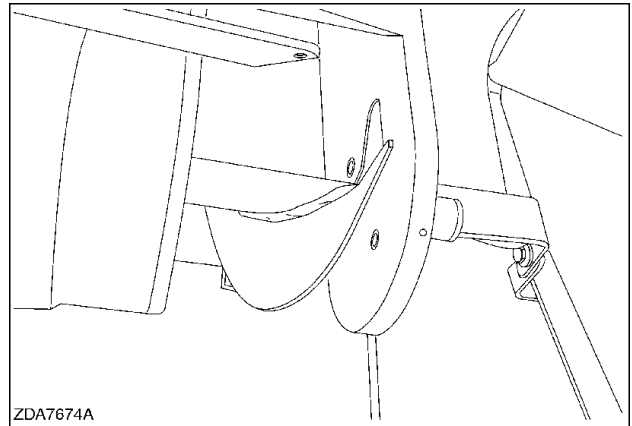

ZDA7674A

ZDA7674A 1

2. Install the bearing housing and tighten the four bolts (5).

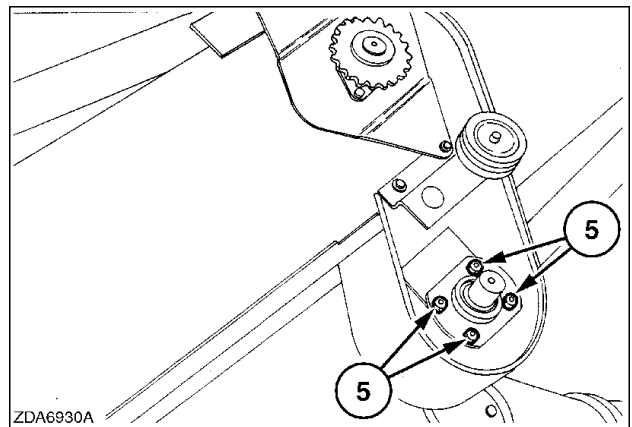

ZDA6930A

ZDA6930A 2

3. At the left-hand side, install the lock collar (5) and tighten the Allen screw.

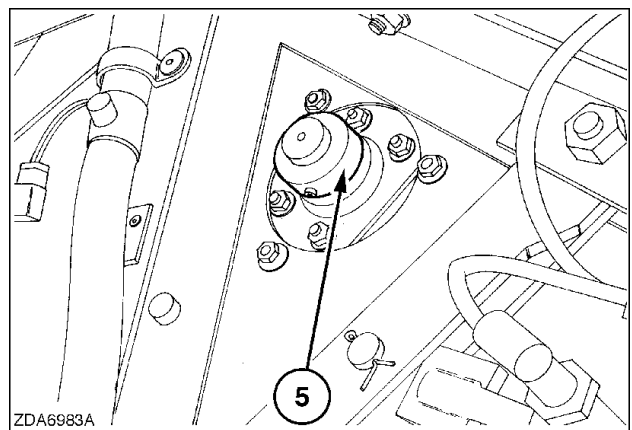

ZDA6983A

ZDA6983A 3

4. Install the sensor plate (4) and tighten it with the bolt (3).
Install the sensor support (2) and tighten it with the two bolts (1).

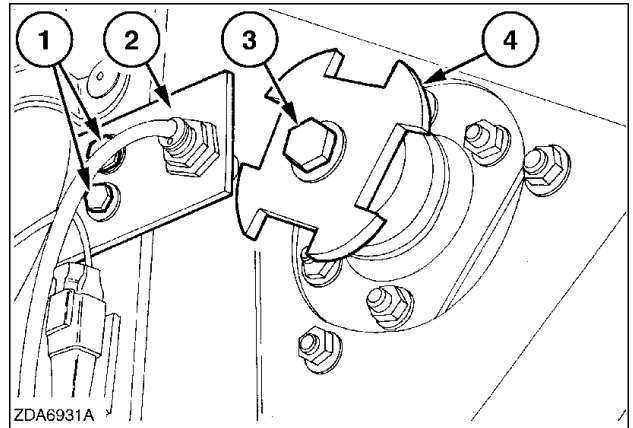

ZDA6931A 4

5. At the right-hand side, install the key, the sprocket (4), the washer and the retaining ring (3).

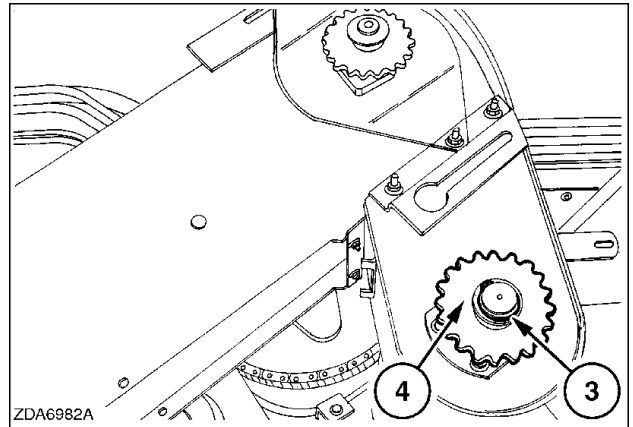

ZDA6982A_204 5

6. Install the returns top auger drive chain and tighten it by moving the idler (1).
Tighten the nut (2).

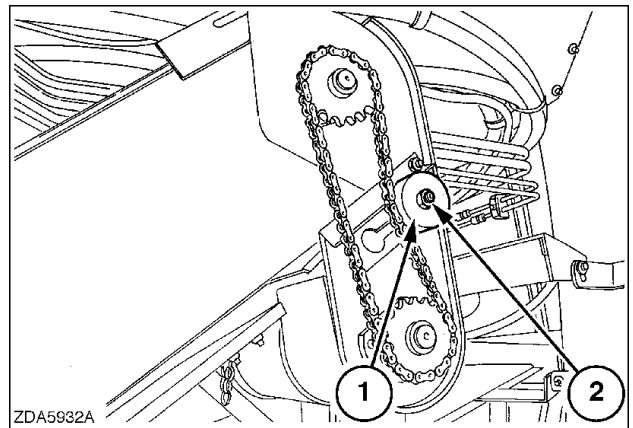

ZDA5932A 6

7. Close the top cover (6).

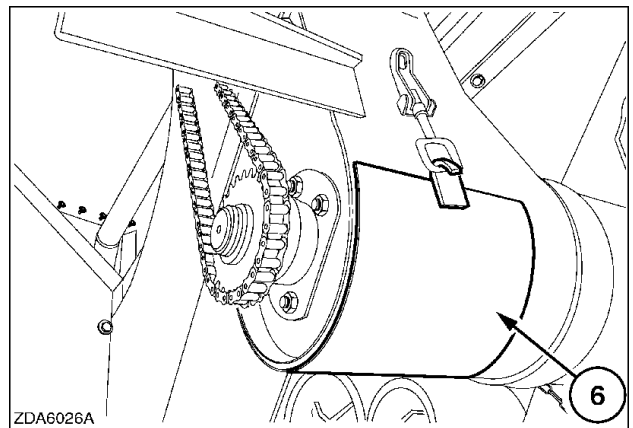

ZDA6026A 7

Tailings elevator Chain - Remove

1. At the left-hand side, loosen the nut (2) of the idler (1) and remove the cotter pins to open the coupler links of the chain.

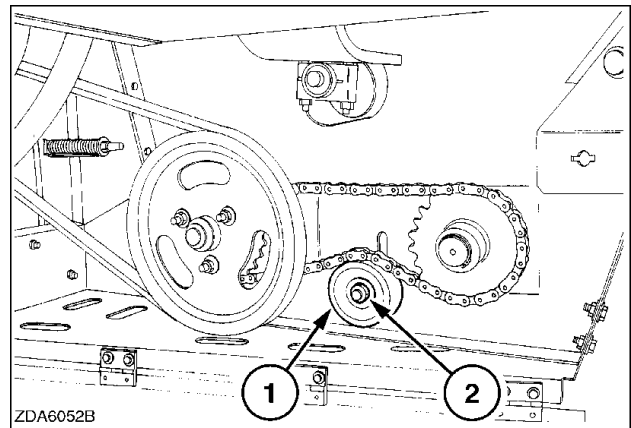

ZDA6052B 1

2. Remove the bolt (4) to open the bottom cover (3) of the returns elevator.

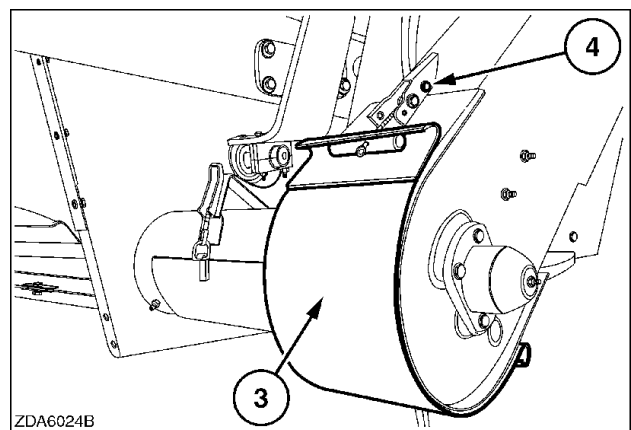

ZDA6024B 2

3. Rotate the elevator chain until the coupler links are accessible on the bottom sprocket.
4. Loosen the nut (3) to release the chain tension. If not, loosen also the locknut (1).

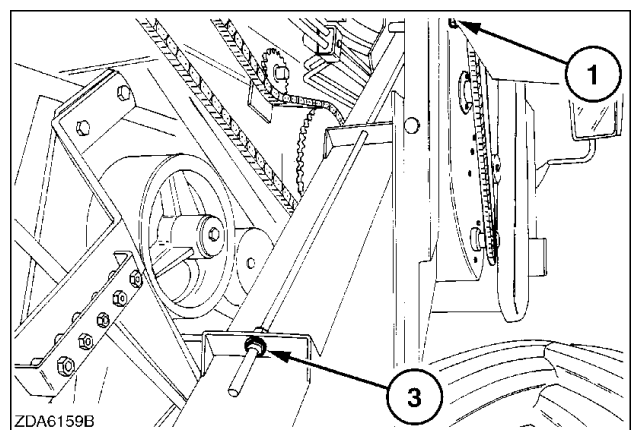

ZDA6159B 3

CROP PROCESSING - CLEANING Tailings return system

5. To open the chain, remove the cotter pin (1), to open the coupler links (2).

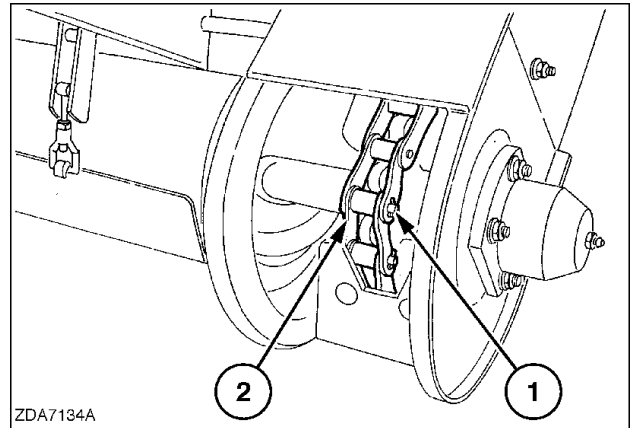

ZDA7134A 4

6. Attach a rope or fit a new chain to the lower part of the returns elevator chain.

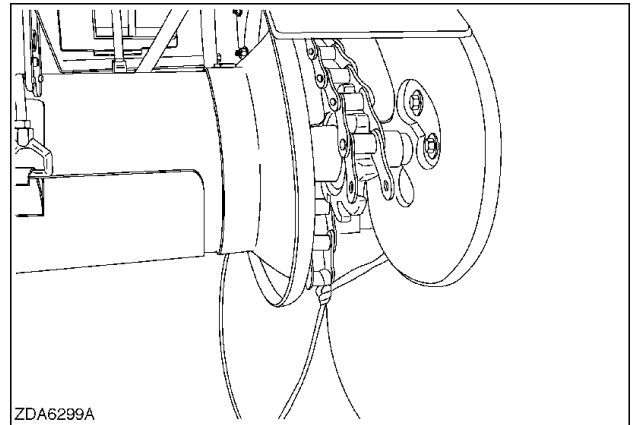

ZDA6299A 5

7. Turn the old chain out.

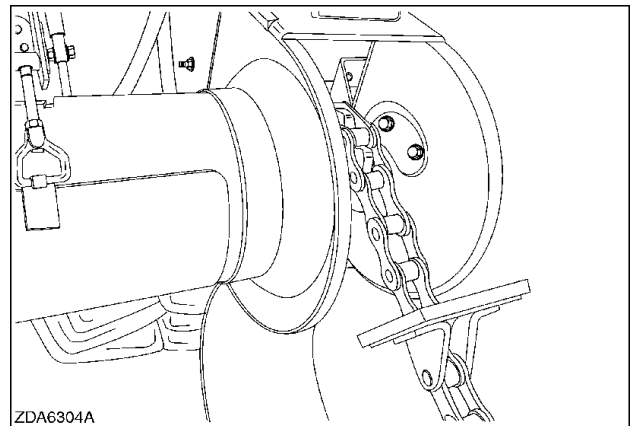

ZDA6304A 6

Tailings elevator Chain - Install

1. Use the rope to pull in the old chain after rework. Disconnect the rope from the old chain, if fit a new chain.

NOTE: Check if the chain is installed in the right direction as shown.

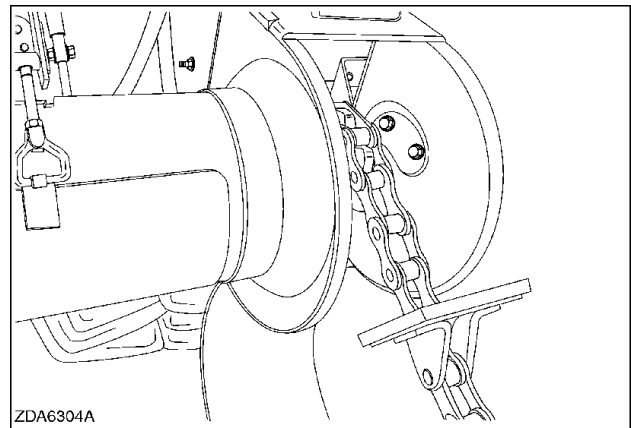

ZDA6304A_198 1

2. Close the chain with the coupler links (2).

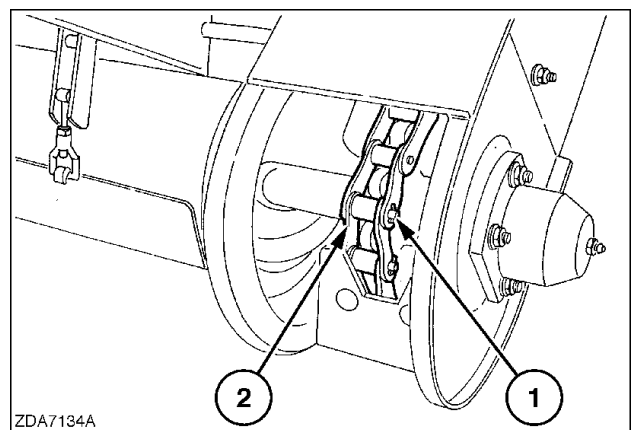

ZDA7134A_199 2

3. Install the cotter pins (1), to secure the coupler links (2).

NOTE: Insert the cotter pins in the direction of travel. (arrow)

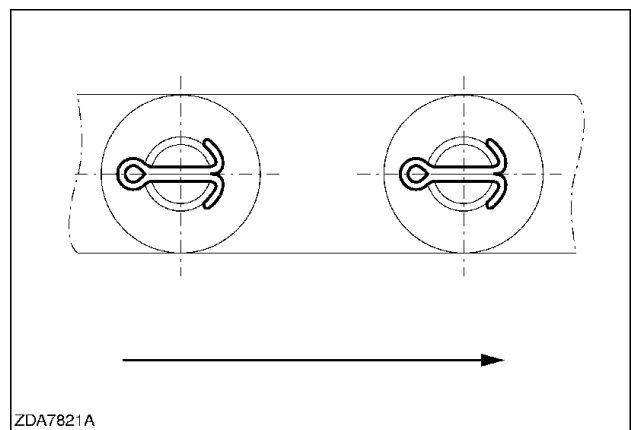

ZDA7821A 3

4. Tighten the chain with the nut (2) and (3).

NOTE: The tension of the returns elevator chain is correct when it is just possible to move a link laterally across the lower sprocket by hand.

NOTE: After adjusting the returns elevator chain, check the tension of the returns top auger drive chain (4) and adjust, if necessary.

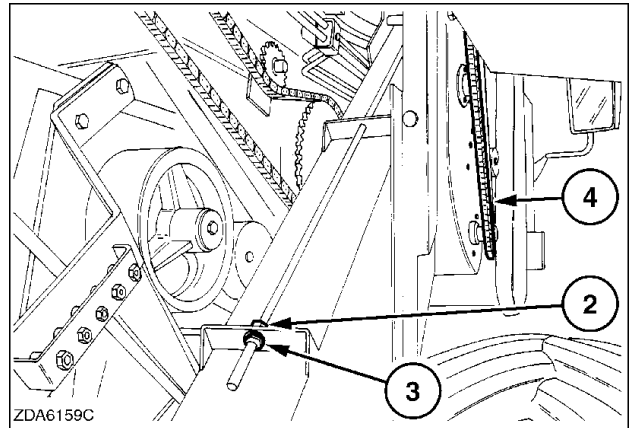

ZDA6159C 4

5. Close the bottom of the returns elevator with the cover (3) and secure it with the bolt (4).

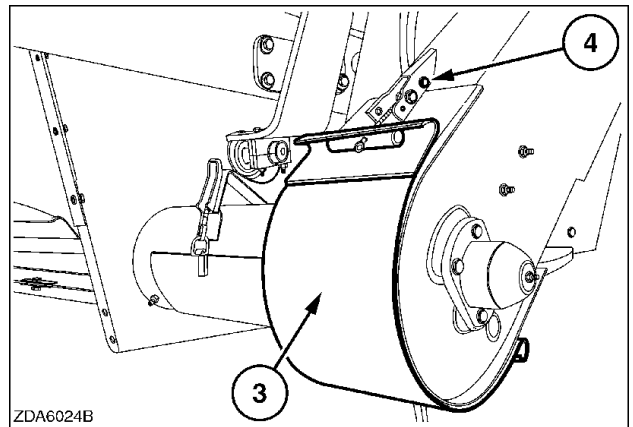

ZDA6024B 5

6. At the left-hand side, install the chain with the coupler links and secure it with the cotter pins.

NOTE: Insert the cotter pins in the direction of travel.

7. Adjust the chain with the idler (1) and tighten the nut (2).

NOTE: Then chain tension is correct when it is just possible to move a link laterally across a sprocket by hand.

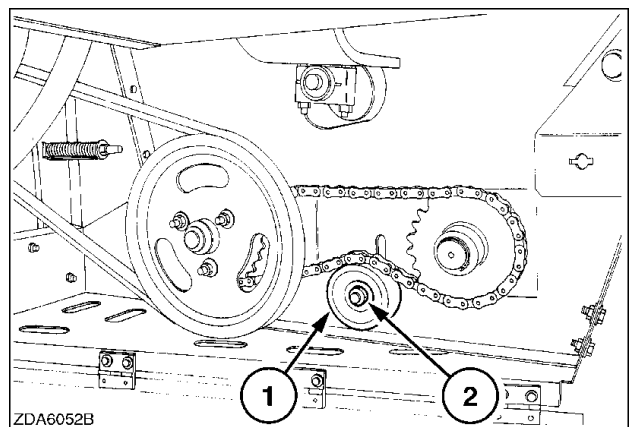

ZDA6052B 6

Tailings elevator - Remove

1. At the left-hand side, Loosen the nut **(2)** of the idler **(1)** and remove the cotter pins to open the coupler links of the chain.

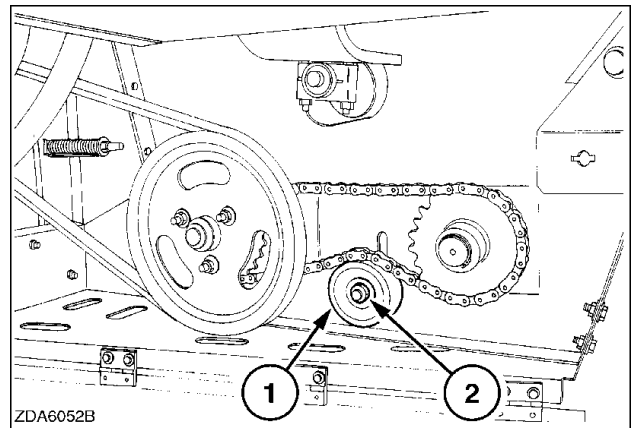

2. At the right-hand side, remove the shielding by removing the bolt **(1)** and the two bolts **(2)**.

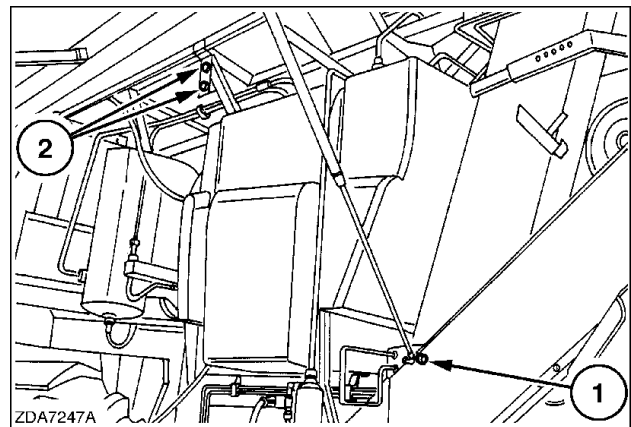

3. Move the idler **(1)** of the returns top auger drive chain by loosening the nut **(2)**. Remove the cotter pins to open the coupler links of the drive chain.

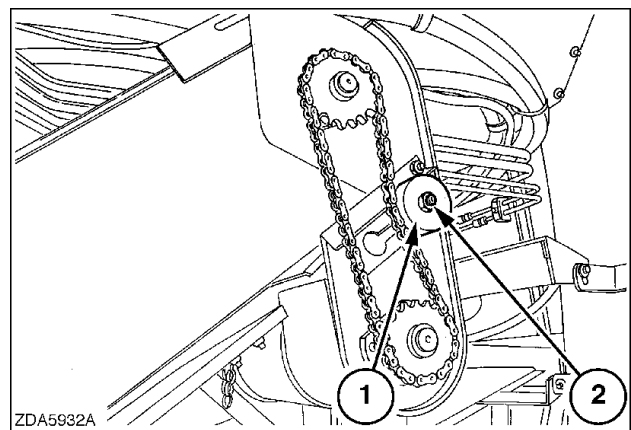

- Remove the bolt (4) to open the cover (3).

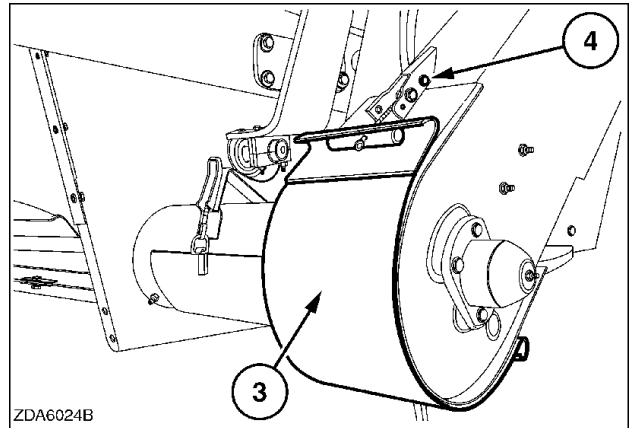

ZDA6024B 4

- Rotate the elevator chain until the coupler links are accessible on the bottom sprocket.
- Loosen the nut (3) to release the chain tension. If not, loosen also the locknut (1).

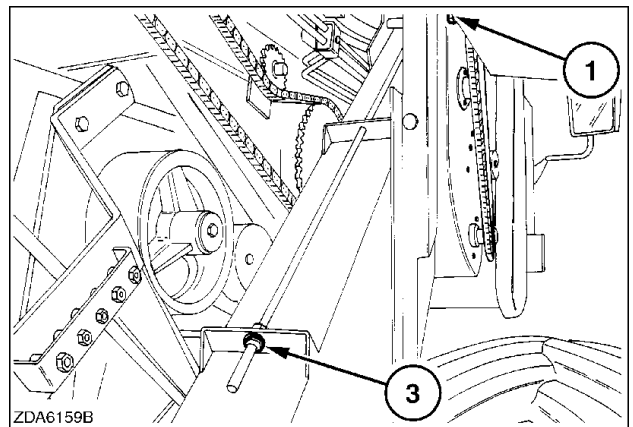

ZDA6159B 5

- To open the chain, remove the cotter pin (1), to open the coupler links (2). To prevent from slipping out of the returns elevator chain, fit a rope on both ends of the chain.

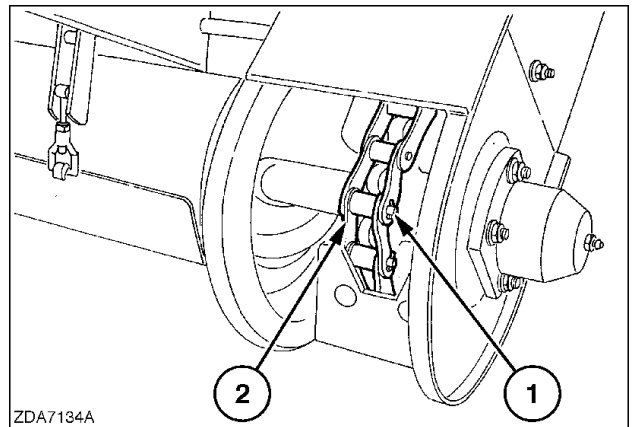

ZDA7134A 6

8. Remove the dowel pin (1) of the sprocket (2).

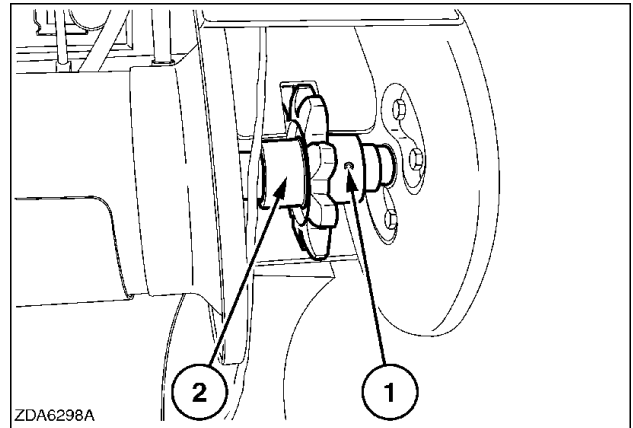

ZDA6298A 7

9. Remove the two nuts (3) and remove the cover (4).

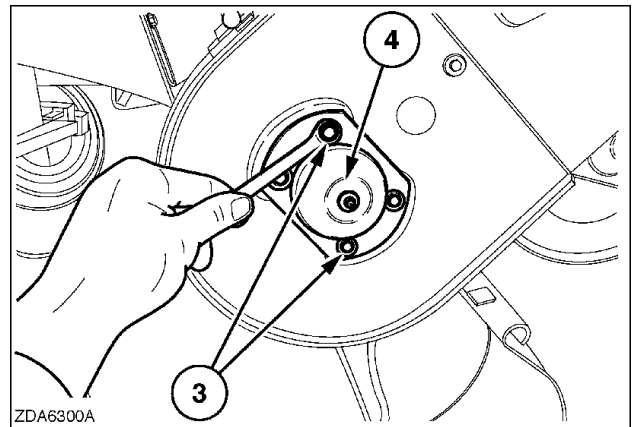

ZDA6300A 8

10. Remove the central bolt (5) and the washers. Remove two nuts (6).

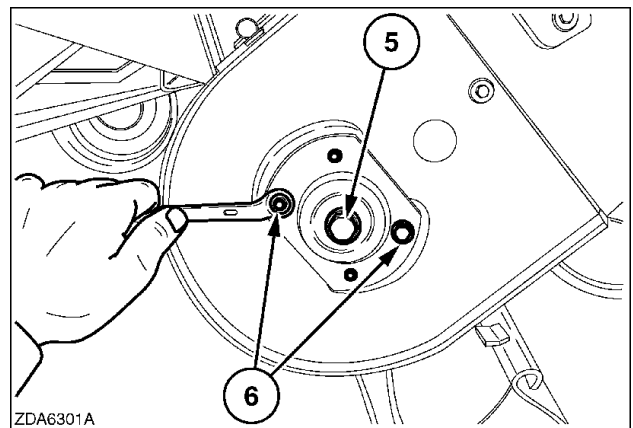

ZDA6301A 9

11. Remove the bearing flange (7), using a puller.

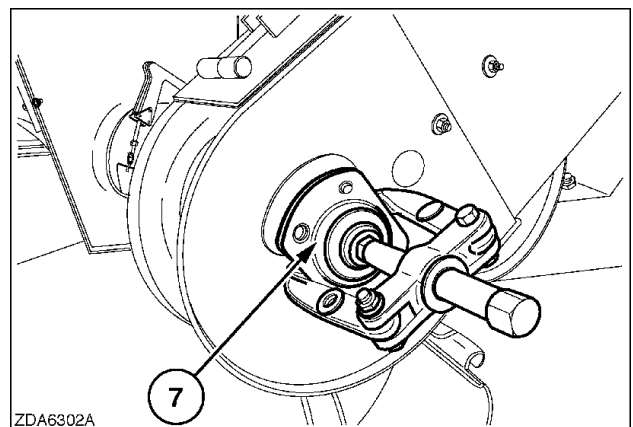

ZDA6302A 10

12. Remove the eight bolts (1) at the top of the returns auger.

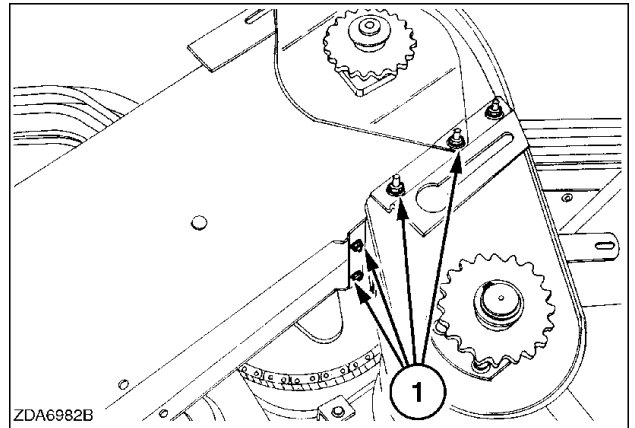

ZDA6982B 11

13. Remove the two bolts (3) at the bottom of the returns cross auger.

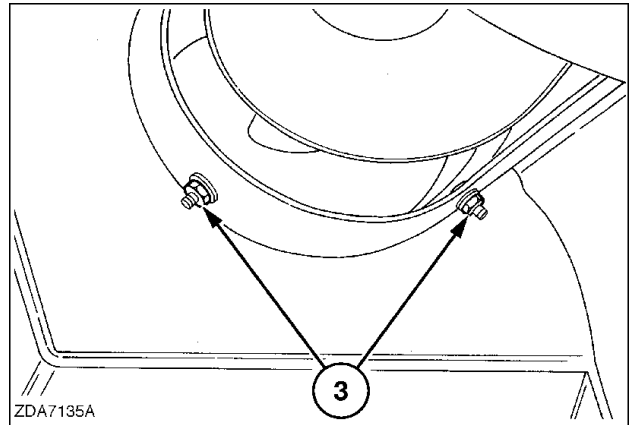

ZDA7135A 12

14. Remove the two bolts (2) that connect the returns elevator with the grain elevator.

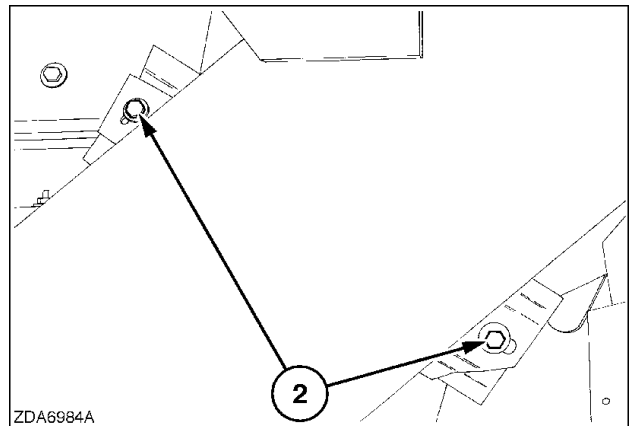

ZDA6984A 13

15. Now is it possible to remove the returns elevator, using an adequate lifting device.

Tailings elevator - Install

1. Bring the returns elevator onto his place. Don't forget to install the sprocket on the returns bottom cross auger.
Install the two bolts (2).

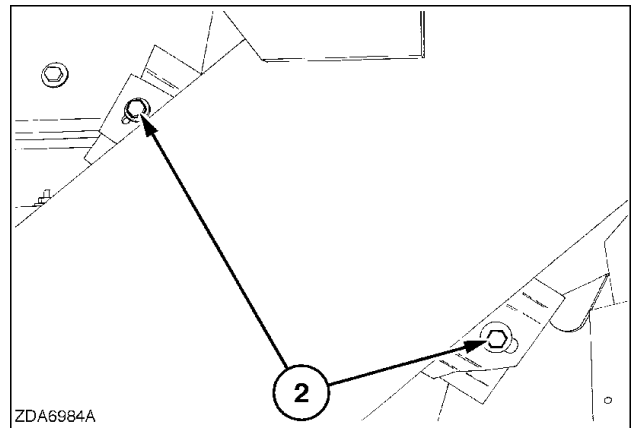

2. Install the eight bolts (1) at the top of the returns elevator.

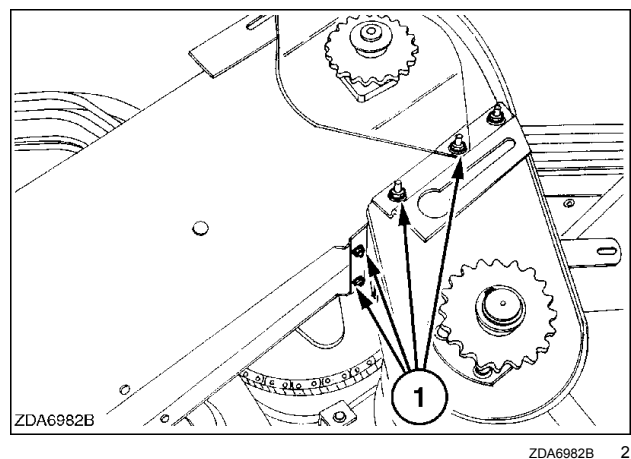

3. Install and tighten the two bolts (3) at the bottom of the returns elevator.

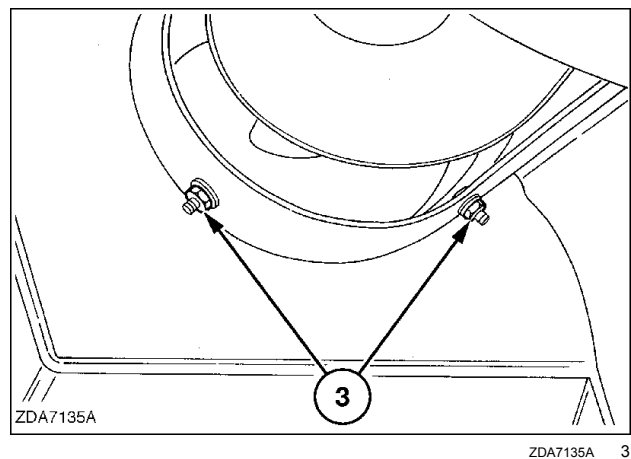

4. Install the bearing flange and tighten the two bolts (6).
Install the washer and tighten the central bolt (5).

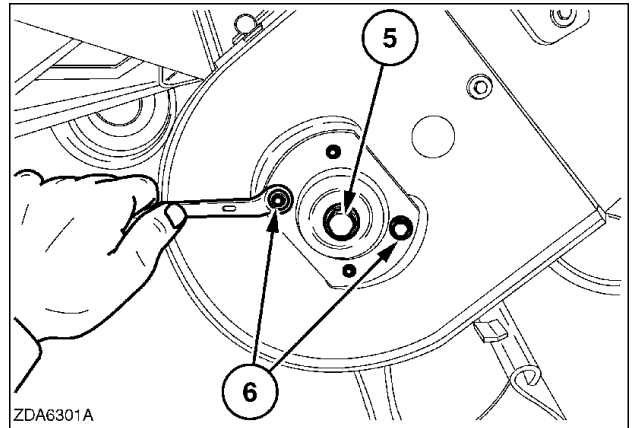

ZDA6301A_201 4

5. Install the grease cover (4) and tighten the two nuts (3).

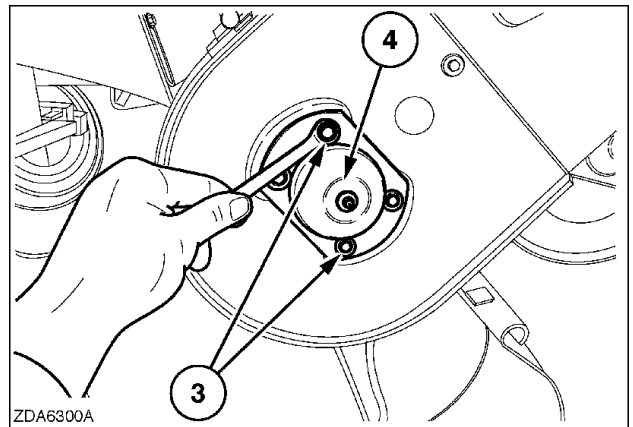

ZDA6300A 5

6. Install the sprocket (2) with the dowel pin (1).

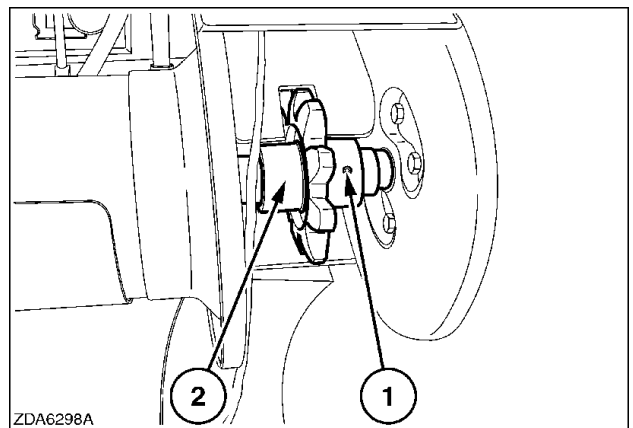

ZDA6298A 6

7. Connect the returns elevator chain with the coupler links (2) and secure them with the cotter pin (1).

NOTE: Insert the cotter pins against the direction of travel.
(Refer to *Tailings elevator Chain - Install (K.62.C)*)

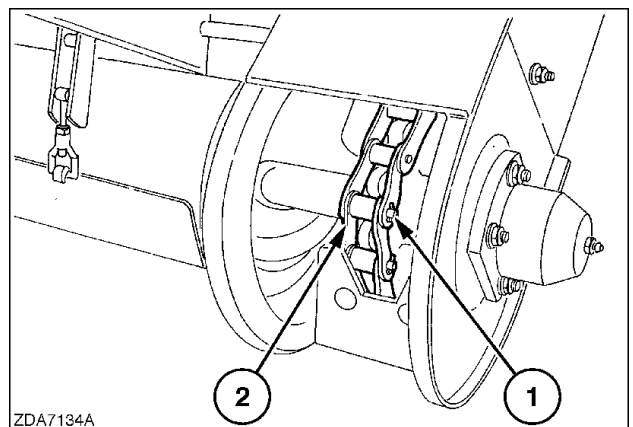

ZDA7134A 7

8. Adjust the chain tension with the nuts (2) and (3).

NOTE: The tension of the returns elevator chain is correct when it is just possible to move a link laterally across the lower sprocket by hand.

NOTE: After adjusting the returns elevator chain, check the tension of the returns top auger drive chain (4).

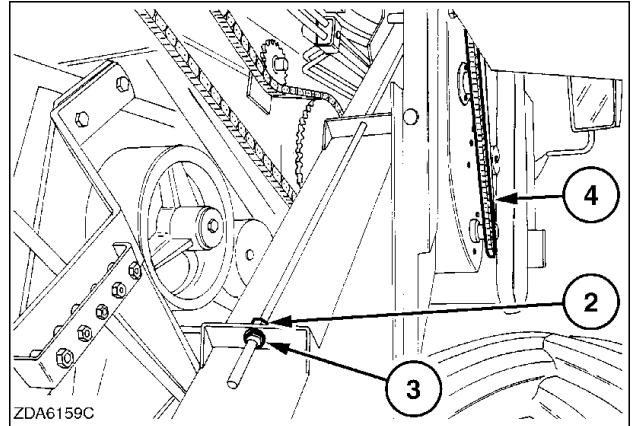

ZDA6159C 8

9. Install the returns top auger drive chain and adjust it by moving idler (1). Tighten the nut (2).

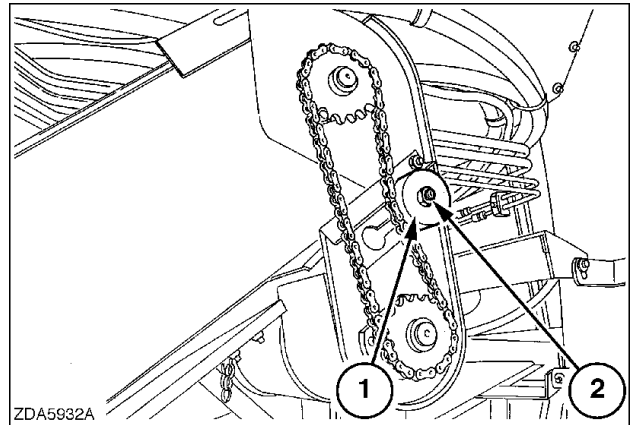

ZDA5932A_202 9

10. Install the cover (3) at the bottom of the returns elevator and secure it with the bolt (4).

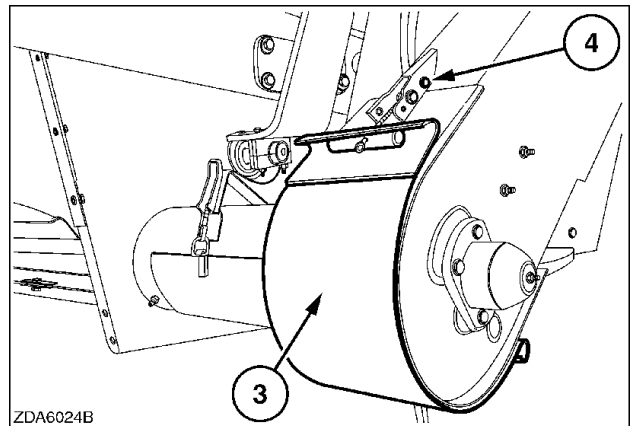

ZDA6024B_203 10

11. Install the shielding and tighten the bolts (1) and (2).

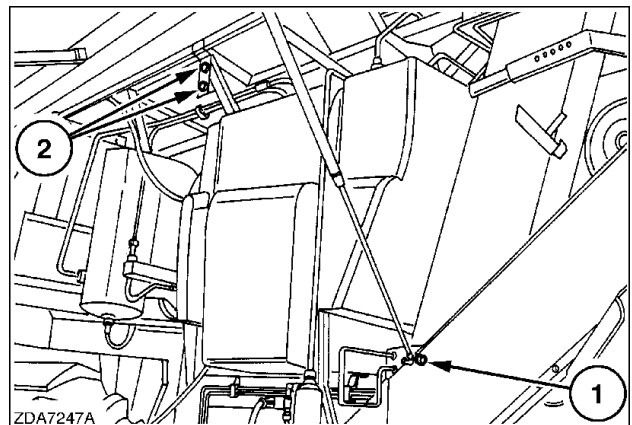

ZDA7247A 11

12. At the left-hand side, close the chain with the coupler links and install the cotter pins. Adjust the chain by moving the idler (1) and tighten it with nut (2).

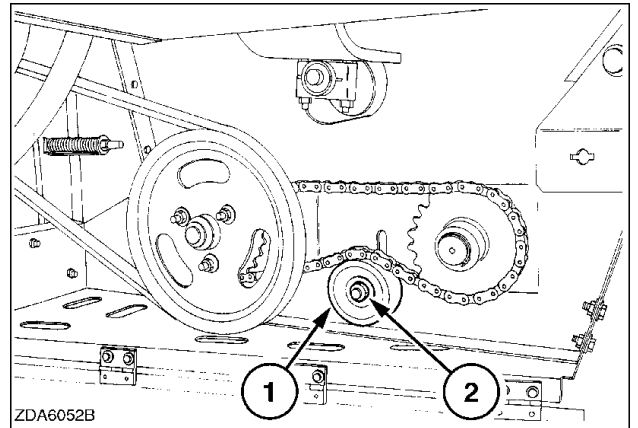

Index

CROP PROCESSING - K

CLEANING Tailings return system - 62.C

Cross auger - Exploded view	3
Cross auger - Install	8
Cross auger - Remove	4
Return auger - Install	14
Return auger - Remove	12
Tailings elevator - Install	24
Tailings elevator - Remove	20
Tailings elevator Chain - Install	18
Tailings elevator Chain - Remove	16



CROP PROCESSING - K

STORING AND HANDLING Grain storing - 60.B

CSX7000

Contents

CROP PROCESSING - K

STORING AND HANDLING Grain storing - 60.B

FUNCTIONAL DATA

Clean grain cross auger

Exploded view	3
---------------------	---

Grain tank

Extension - Exploded view	5
CSX7080, CSX7080 Laterale	

Extension - Detailed view	6
CSX7080, CSX7080 Laterale	

SERVICE

Clean grain cross auger

Remove	7
--------------	---

Install	11
---------------	----

Grain elevator

Chain - Remove	15
----------------------	----

Chain - Install	17
-----------------------	----

Remove	19
--------------	----

Install	22
---------------	----

Tank delivery auger

Remove	25
--------------	----

Install	27
---------------	----

Grain tank

Extension Gas strut - Remove	30
CSX7080 Laterale	

Extension Gas strut - Install	32
CSX7080 Laterale	

Extension Lever - Remove	34
CSX7080 Laterale	

Extension Lever - Install	35
CSX7080 Laterale	

Extension - Remove	38
CSX7080, CSX7080 Laterale	

Extension - Install	42
CSX7080, CSX7080 Laterale	

Extension Lever arm - Remove	46
CSX7080, CSX7080 Laterale	

Extension Lever arm - Install	48
CSX7080, CSX7080 Laterale	

Clean grain cross auger - Exploded view

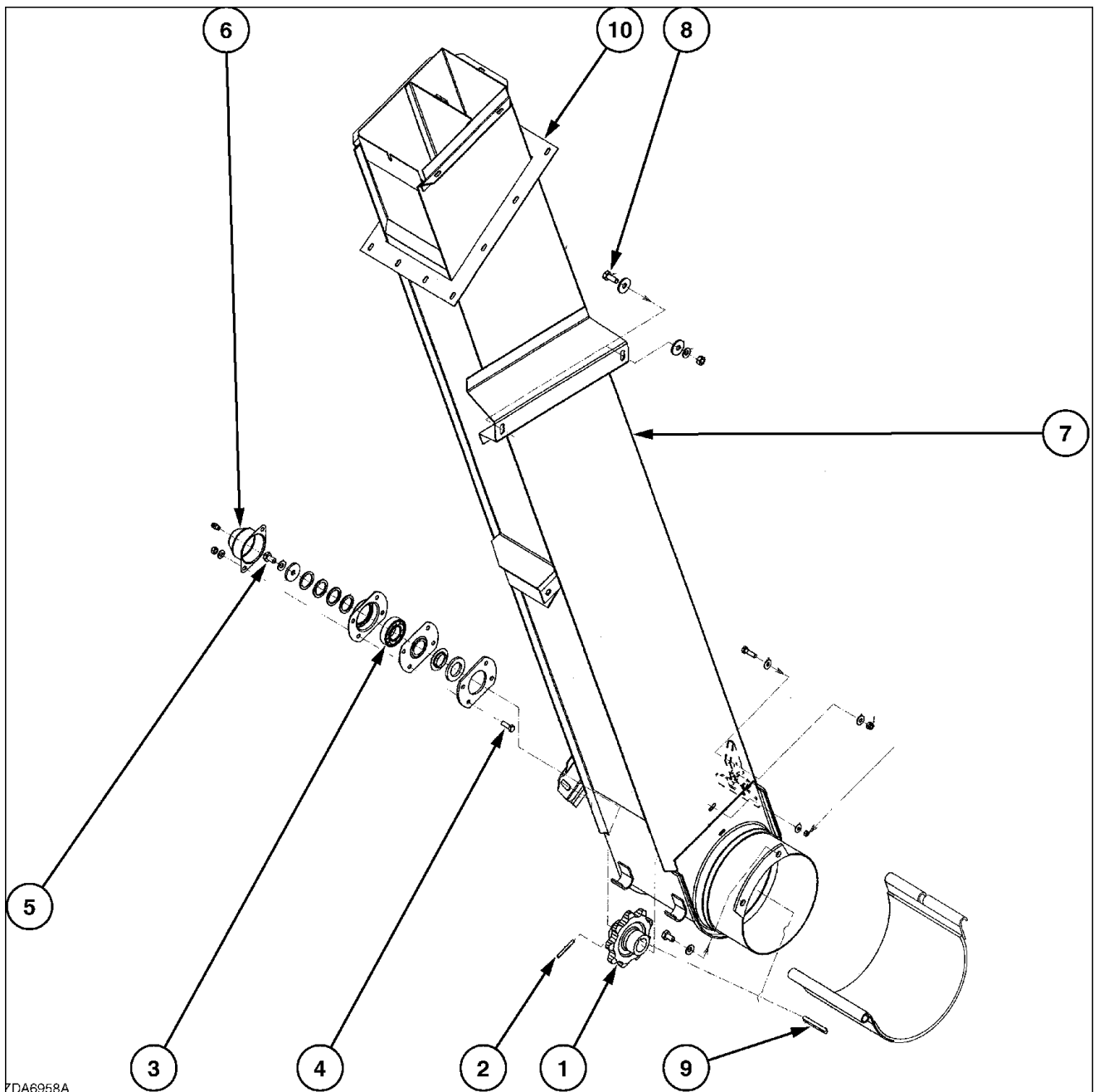

ZDA6958A

ZDA6958A 1

Right-hand side

- | | |
|------------------|----------------|
| 1 Sprocket | 2 Dowel pin |
| 3 Bearing | 4 Bolt |
| 5 Central bolt | 6 Grease cover |
| 7 Grain elevator | 8 Bolt |
| 9 Key | 10 Seal plate |

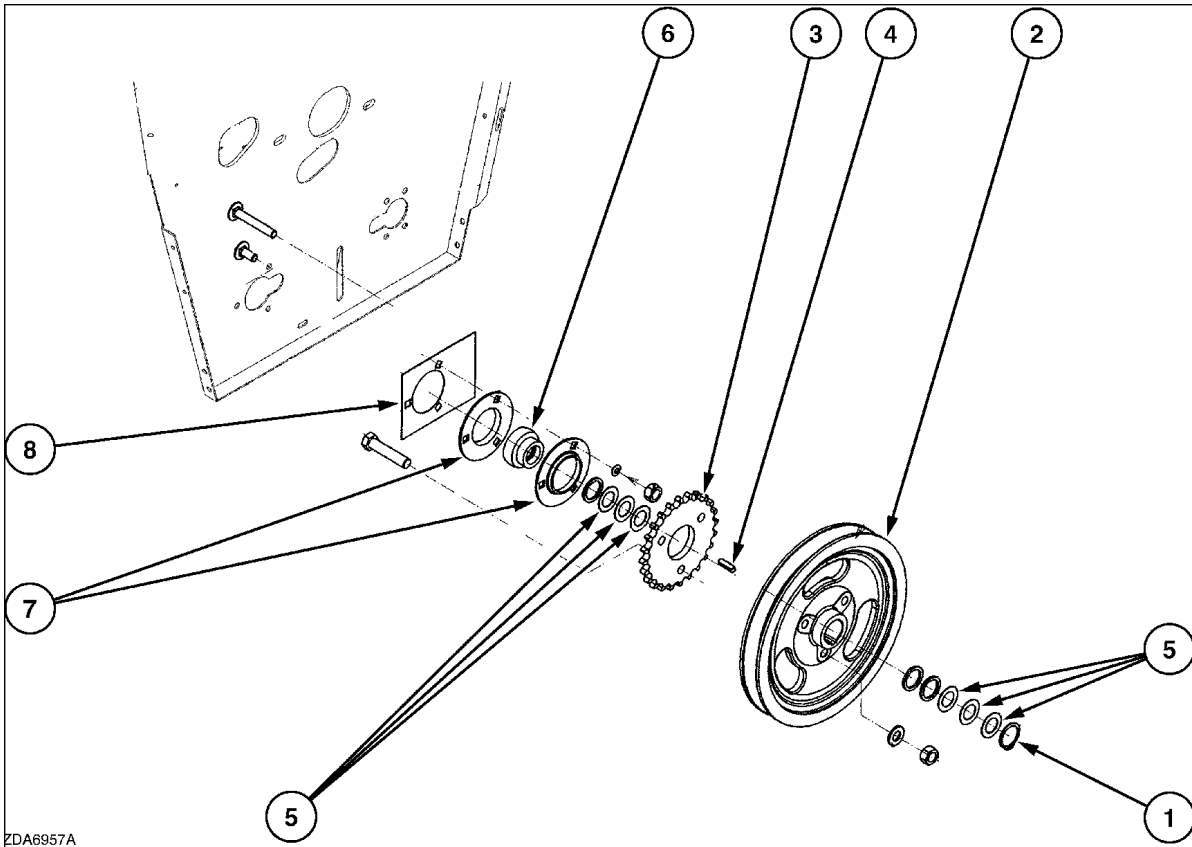

ZDA6957A

ZDA6957A 2

Left-hand side

- 1 Retaining ring
- 3 Sprocket
- 5 Washers
- 7 Bearing flange

- 2 Pulley
- 4 Key
- 6 Bearing
- 8 Plate

Grain tank Extension - Exploded view

CSX7080, CSX7080 Laterale

- | | |
|-------------------------|---------------|
| 1. Grain tank extension | 43. Arm |
| 2. Lever | 44. Bolt |
| 18. Lever arm | 45. Bolt |
| 33. Bracket | 46. Lever arm |
| 40. Cover | 47. Bolt |
| 41. Bolt | 50. Bolt |
| 42. Bolt | 51. Tie rod |

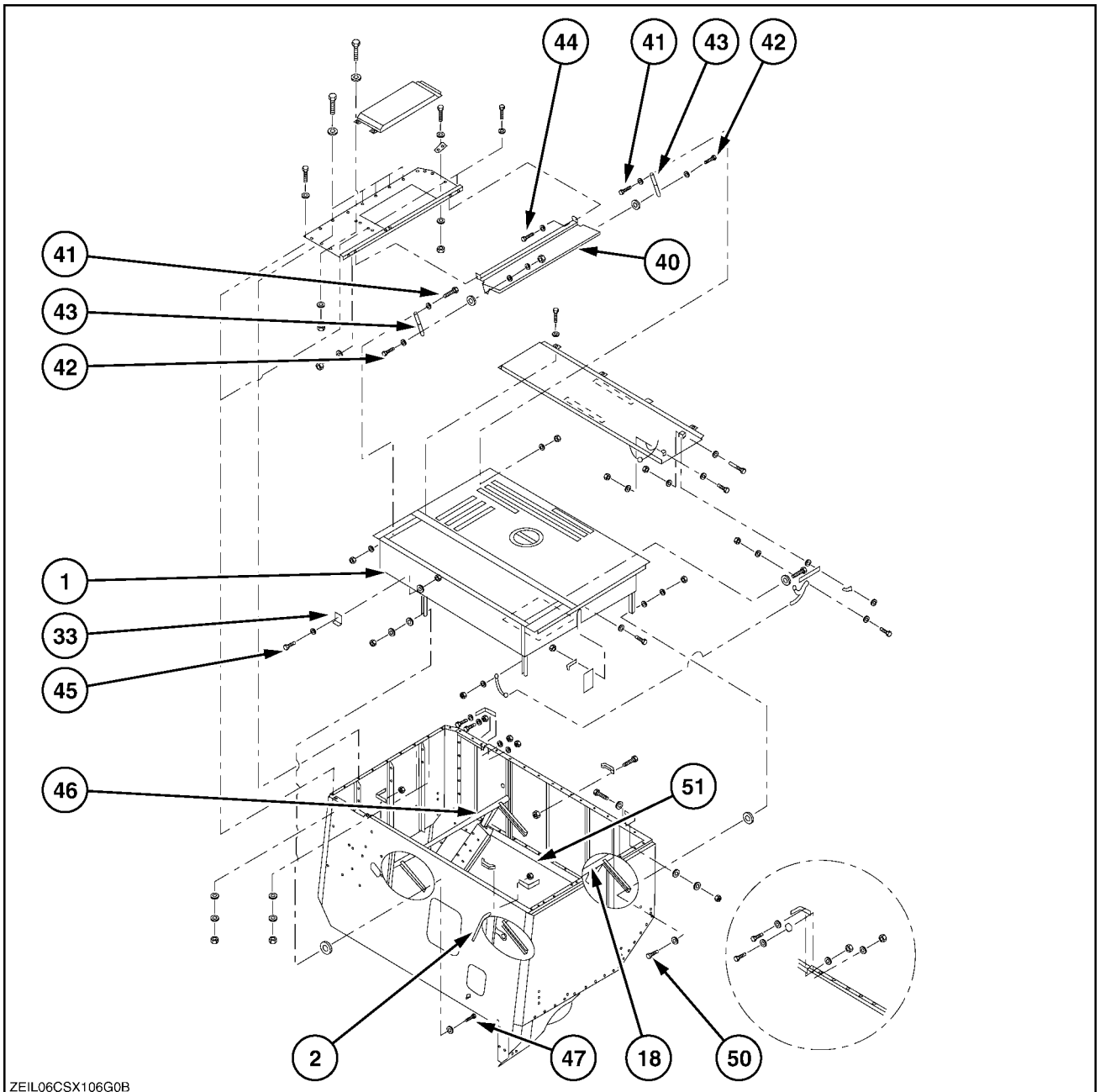

ZEIL06CSX106G0B

ZEIL06CSX106G0B 1

Grain tank Extension - Detailed view

CSX7080, CSX7080 Laterale

- | | | | |
|--------------|-----------------|--------------------|--------------------|
| 2. Lever | 14. Arm | 24. Lock nut | 51. tie rod |
| 3. Bolt | 15. Roll pin | 25. Cone | 52. Bolt |
| 4. Nut | 16. Nut | 26. Shaft | 53. Bracket |
| 5. Bracket | 17. Coach bolt | 27. Nut | 54. Plate |
| 6. Bolt | 18. Lever arm | 28. Nut | 55. Bolt |
| 7. Gas strut | 19. Knob | 29. Bolt | 56. Bolt |
| 8. Lock nut | 20. Lock nut | 30. Bearing | 57. Bracket |
| 11. Plate | 21. Washer | 31. Bearing flange | 58. Bolt |
| 12. Nut | 22. Rod | 32. Plate | 59. Bracket |
| 13. Lock nut | 23. Flat washer | 46. Lever arm | 60. Retaining ring |

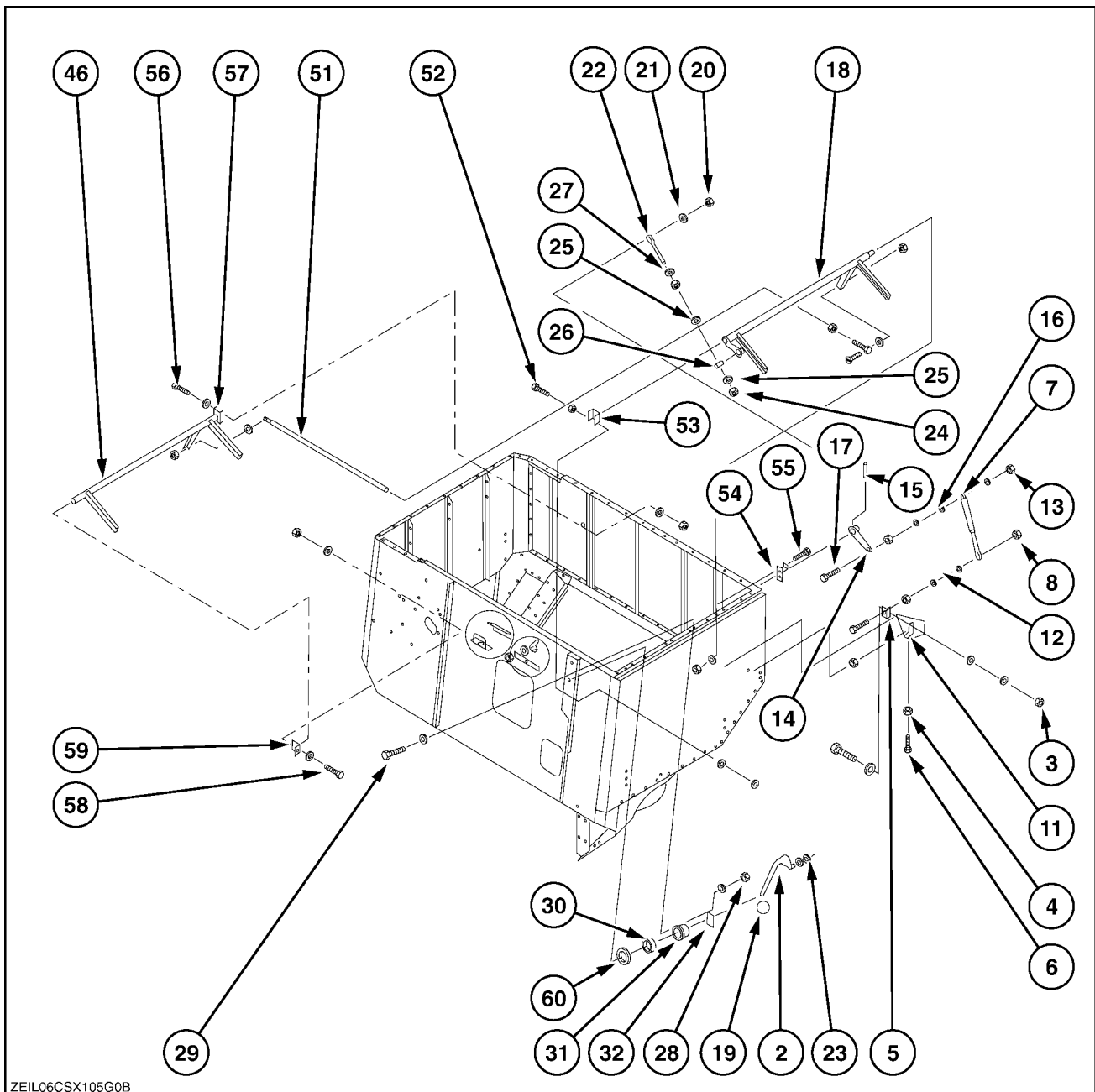

ZEIL06CSX105G0B

ZEIL06CSX105G0B 1

Clean grain cross auger - Remove

1. At the left-hand side, loosen the nut **(2)** of the idler **(1)**.
Remove the cotter pins to open the coupler links of the drive chain.

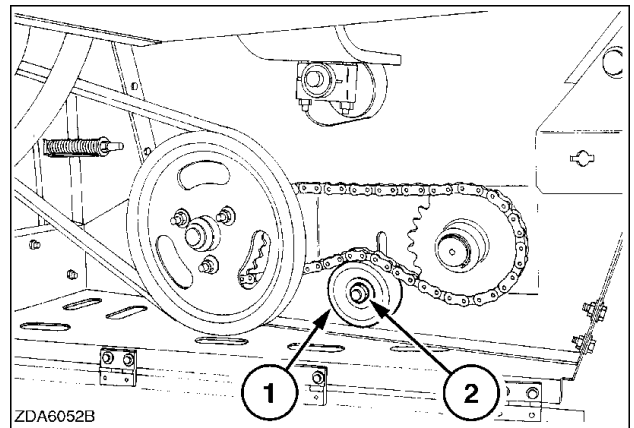

2. Loosen the nut **(1)** and remove the drive belt **(2)** from the pulley.

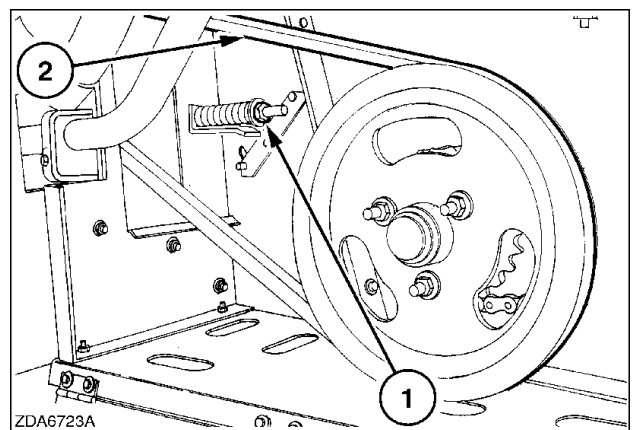

3. At the right-hand side, remove the bolt **(3)**.
Open the bottom cover **(2)** of the grain elevator.

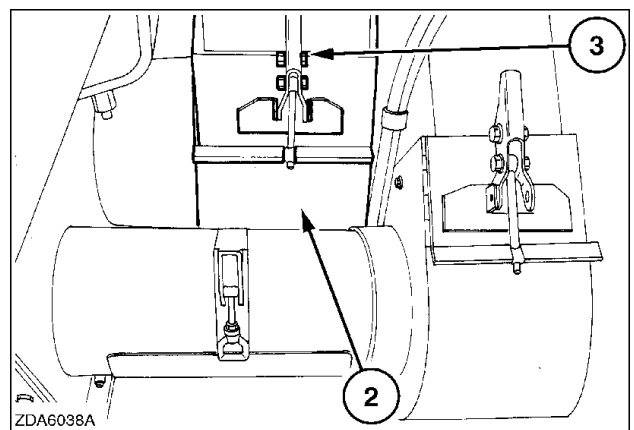

4. Rotate the elevator chain until the coupler links are accessible on the bottom sprocket.

5. Loosen the nut **(2)** and **(3)** to release the grain elevator chain. If not, loosen also the nut **(1)**.

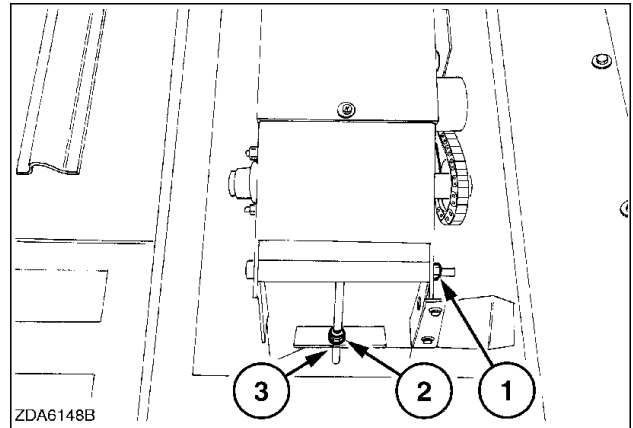

ZDA6148B_210 4

6. To open the chain, remove the cotter pin **(1)**, to open the coupler links **(2)**. To prevent from slipping out of the grain elevator chain, fit a rope on both ends of the chain.

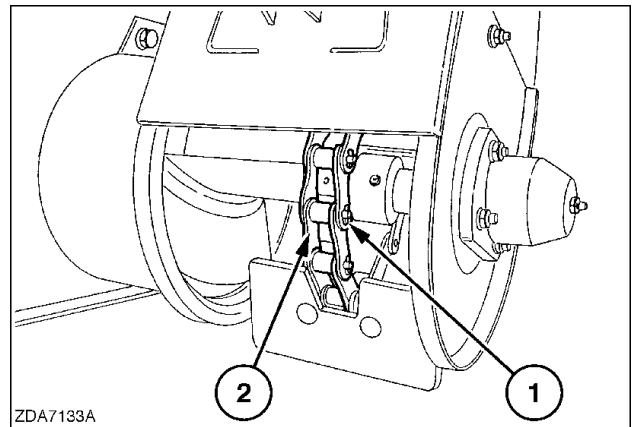

ZDA7133A 5

7. Remove the dowel pin **(1)** out of the sprocket **(2)**.

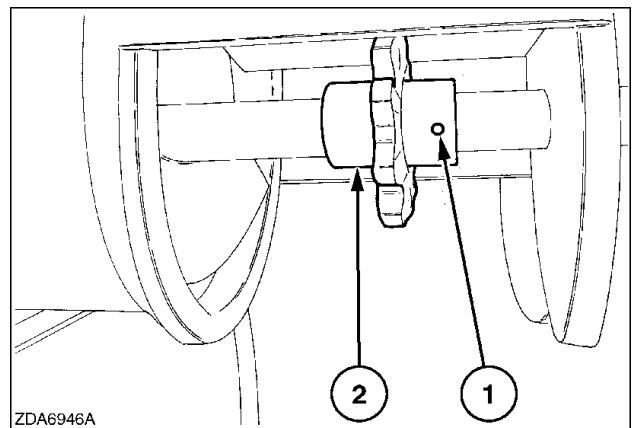

ZDA6946A 6

8. Remove the two nuts **(3)** and remove the grease cover **(4)**.

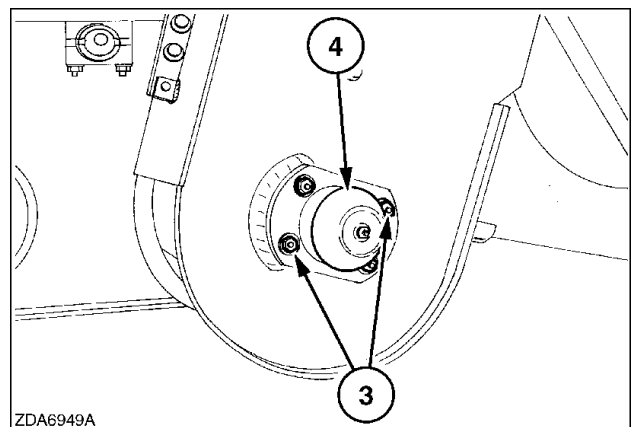

ZDA6949A 7

9. Remove the central bolt (5) and the washer.
Remove two nuts (6).

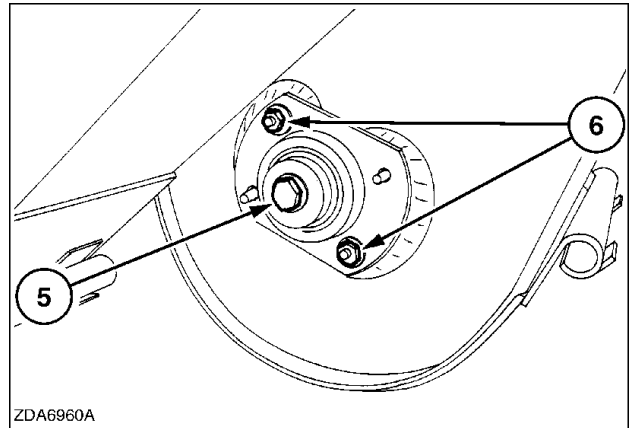

ZDA6960A 8

10. Remove the bearing flange (7), using a puller.

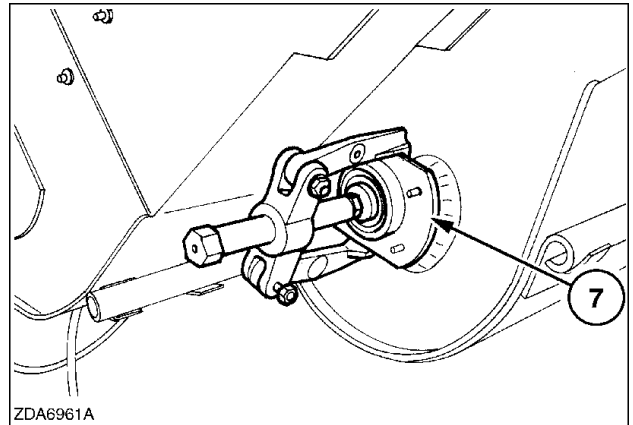

ZDA6961A 9

11. At the left-hand side, remove the retaining ring (1).
Remove the V-pulley (2) by using a puller.

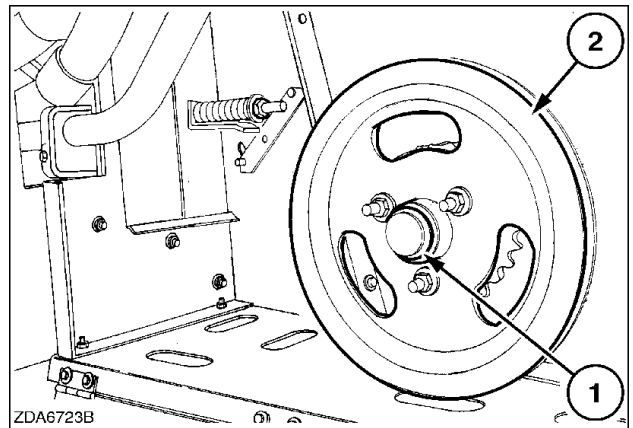

ZDA6723B 10

12. Remove the key (3) and the washers.
Loosen the Allen screw and remove the lock collar (4).

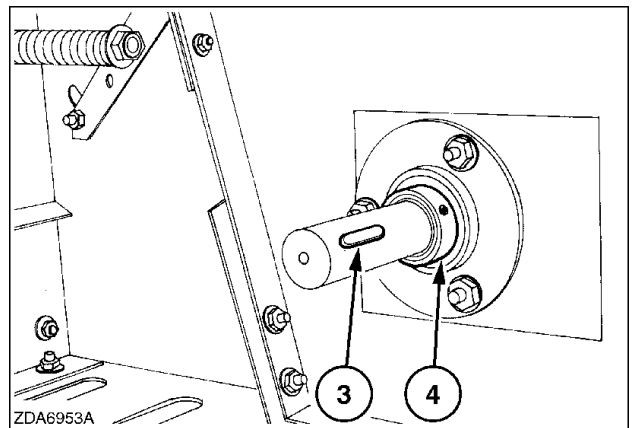

ZDA6953A 11

13. Loosen the three nuts **(5)** of the bearing flange.

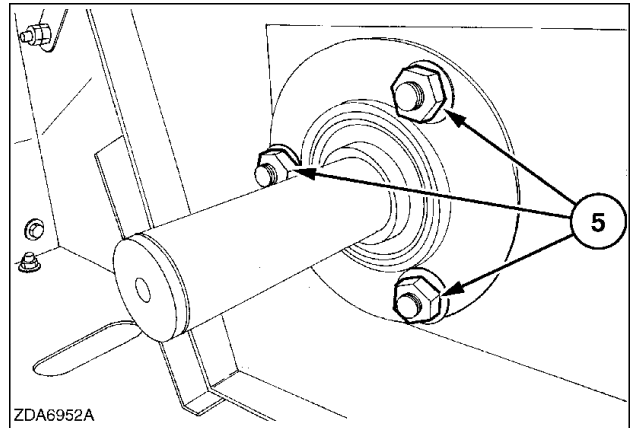

ZDA6952A 12

14. Remove the bearing **(6)** with the flanges **(7)**.
Remove the plate **(8)**.

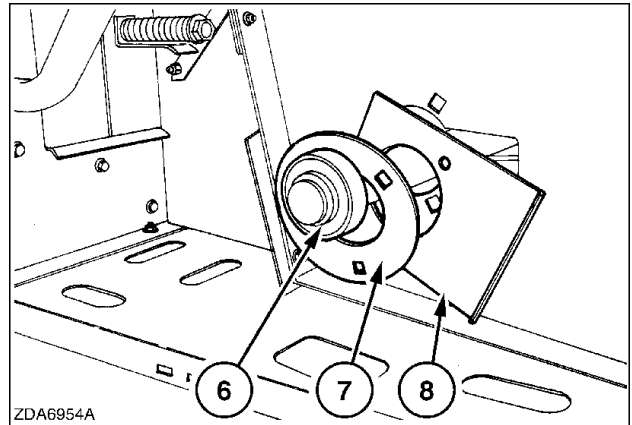

ZDA6954A 13

15. Turn out the auger through the long sleeve hole at the left-hand side.
At the right-hand side, remove the sprocket.

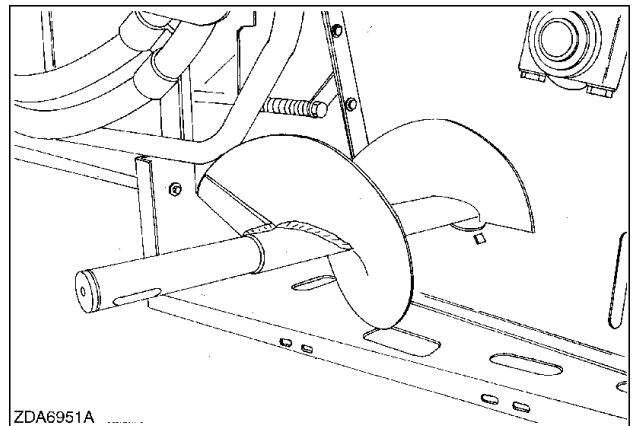

ZDA6951A 14

Clean grain cross auger - Install

1. Install the auger from the left-hand side by rotating the auger until it is completely in its auger housing.

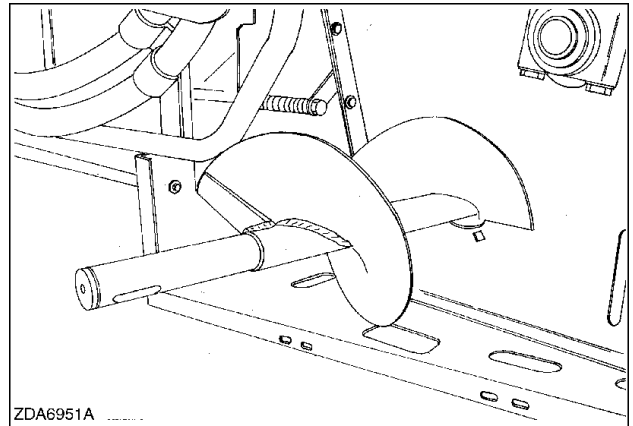

ZDA6951A 1

2. At the left-hand side, install the plate, the bearing with the flanges and tighten the nuts (5).

NOTE: Grease the spherical outer ring with grease NLGI-2 and grease the inner ring of the bearing with anti-corrosive grease.

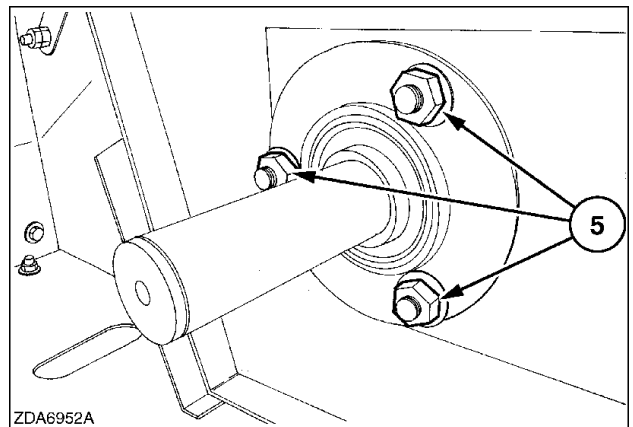

ZDA6952A 2

3. Install the sprocket (1) with the dowel pin (2). (right-hand side)

NOTE: Check if the key (3) is installed.

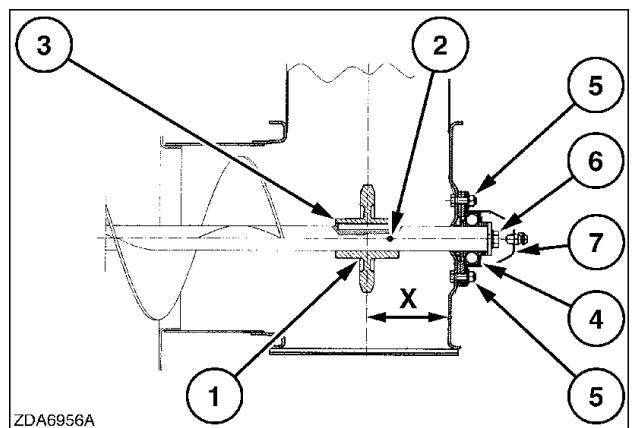

ZDA6956A 3

4. Install the right-hand side bearing (4) and tighten the two nuts (5).

NOTE: Grease the spherical outer ring with NLGI-2 and grease the inner ring of the bearing with anti-corrosive grease.

5. Install the shims, the washer and tighten the central bolt (6).

NOTE: Check if the distance "X" is between 96.5 - 98.5 mm. (3-13/16 - 3-7/8 in)

6. Install the cover (7) and tighten the other two nuts (5).

7. Grease the bearing.
8. At the left-hand side, install and tighten the lock collar (4).
Install the washers and the key (3).

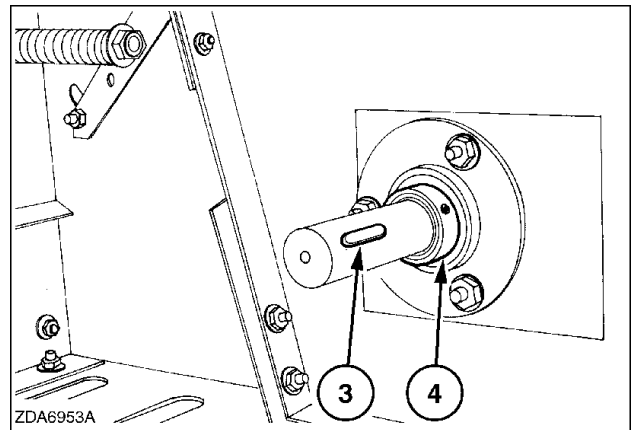

ZDA6953A_211 4

9. Install the pulley (2).

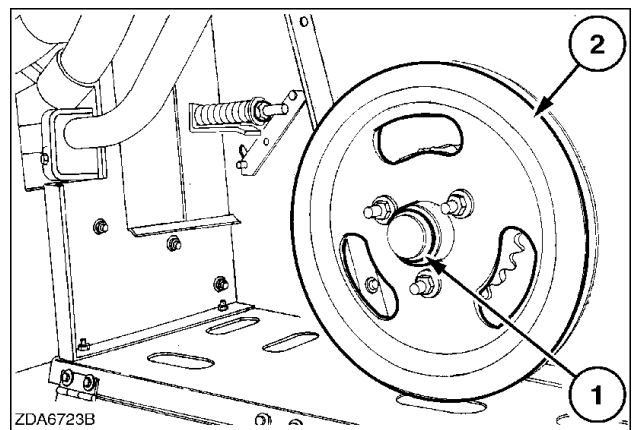

ZDA6723B 5

10. Install the retaining ring (1). (see fig. 5)

NOTE: Check if the distance "X" = 90 mm (3-1/2 in) or in line is with the pulley (3).

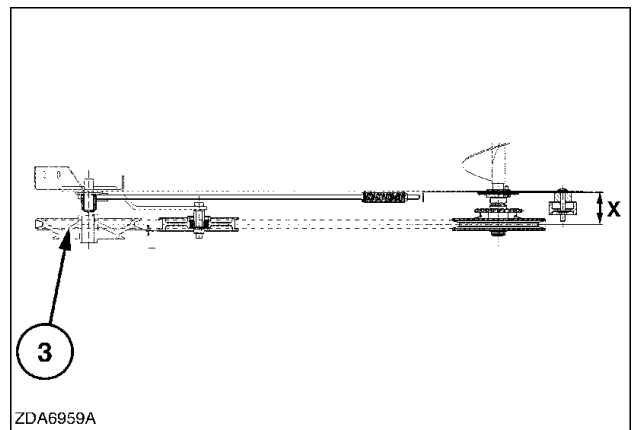

ZDA6959A 6

11. Close the grain elevator chain, with the coupler links (2).
Install the cotter pins (1) to secure the coupler links (2).

NOTE: Insert the cotter pins in the direction of travel.

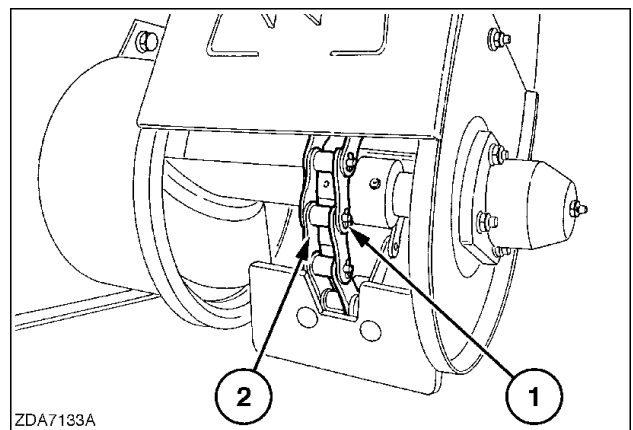

ZDA7133A 7

12. Adjust the grain elevator chain tension with the nuts **(2)** and **(3)**.

NOTE: The tension is correct when the chain can be moved axial across the lower sprocket by hand.

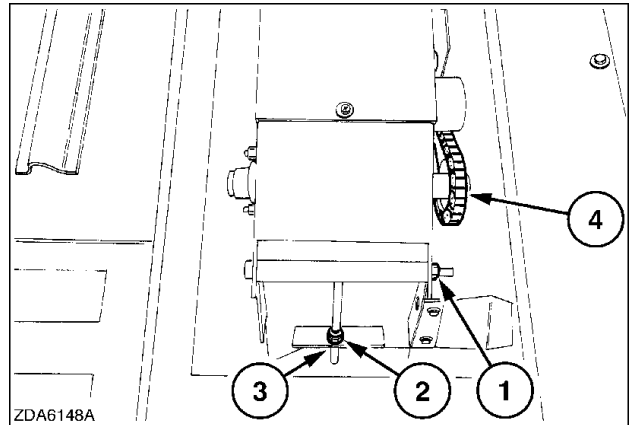

ZDA6148A_212 8

13. After adjusting the grain elevator chain, check the tension of the grain tank filling auger drive chain **(4)**.
14. Close the bottom cover **(2)** of the grain elevator. Secure the cover with the bolt **(3)**.

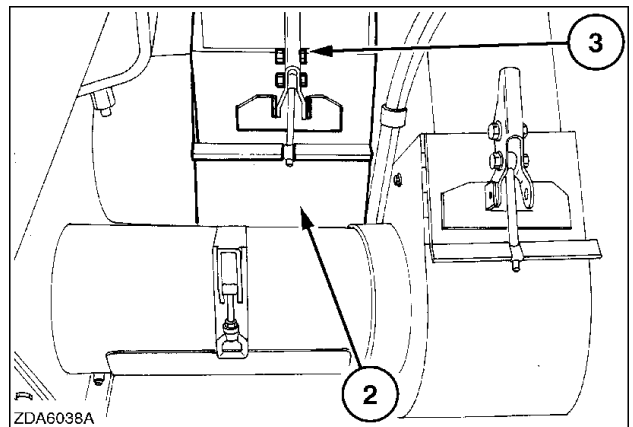

ZDA6038A 9

15. Install the drive belt **(2)** and adjust the belt with the nut **(1)** as described in your Operator's Manual: "SECTION 4 - LUBRICATION AND MAINTENANCE"; paragraph headed: "Drive belts and Chains".

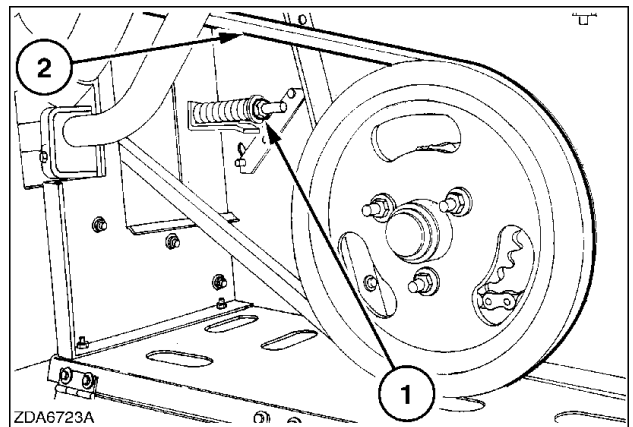

ZDA6723A 10

16. Install and close the drive chain with the coupler links and install the cotter pins.
Adjust the idler (2) and tighten it with the nut (1).

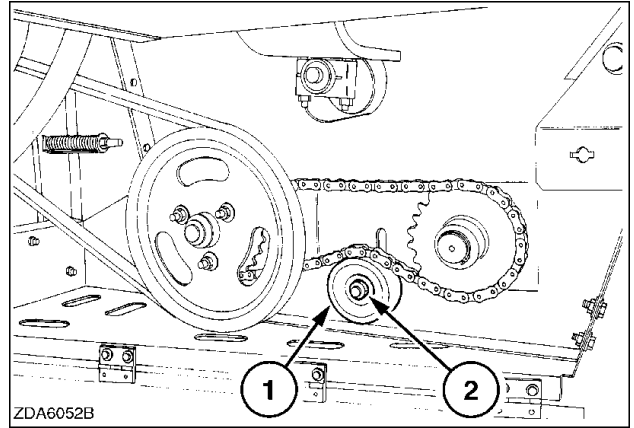

ZDA6052B_208 11