

Fig 110.

866140B

- 3 Install and tighten the screws (066) to 200-230 Nm (140-165 lbf ft) → [Fig 111.](#) ([E-129](#)).

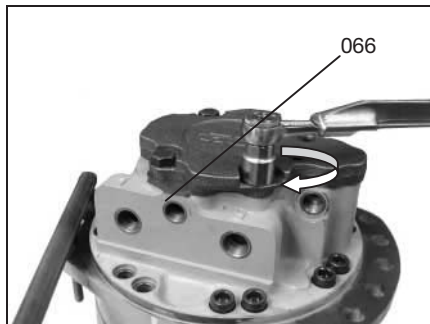

Fig 111.

866140C



Page left intentionally blank

Valves

Loader Valve

Removal

Remove front floor plate → [Floor Plates \(B-1\)](#).

⚠ WARNING

Hydraulic Pressure

Hydraulic fluid at system pressure can injure you. Before disconnecting or connecting hydraulic hoses or couplings, vent the pressure trapped in the hoses in accordance with the instructions given in this publication.

HYD-1-5

Before working on the hydraulic system ensure that the engine is switched off and the starter key removed.

Operate the control levers to vent the hydraulic pressure.

Drain the hydraulic tank.

Disconnect the clevises from the tops of the valve spools 1.

Disconnect all hydraulic hoses from the valve ports (one inlet **A**, four work ports **B** and one outlet **C**). Cover exposed connections to prevent ingress of dirt. Mark the hoses to ensure correct reconnection.

Remove the securing bolts **2** and lift the valve block **3** from the machine.

Replacement

Replacement is a reversal of the removal procedure.

If a new valve block is being fitted it will be necessary to transfer the adapters from the old valve block. Use new 'O' rings.

Ensure all hoses and ports are clean and free from dirt.

Torque Settings

Item	Nm	kgf m	lbf ft
2	56	5.7	42

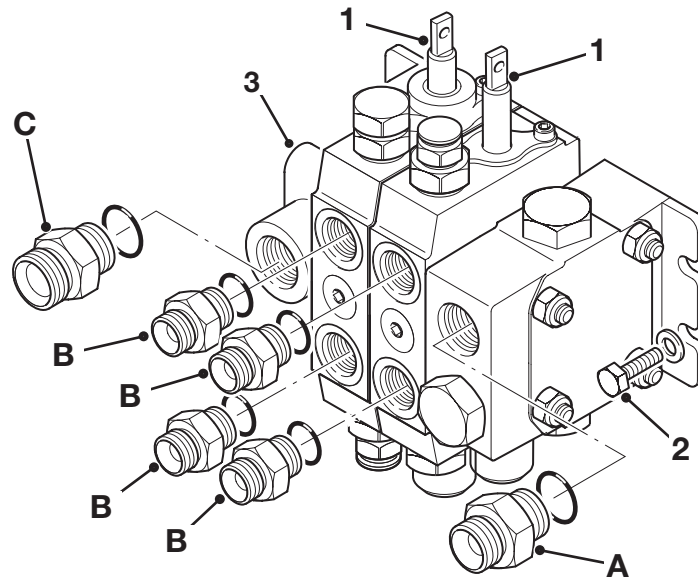

Fig 1.

708211-1

Dismantling and Assembly

When Dismantling

CAUTION: Absolute cleanliness is essential when stripping and assembling hydraulic components.

Note: It is not necessary to separate valve sections to remove spools, connections, relief valves etc. from the valve block.

- 1 Remove nuts **A** from end cover **B** and remove cover from valve.
- 2 Withdraw the valve sections from the tie rods **C**.
- 3 Remove and discard 'O' rings **D**.

Inspection

- 1 Check the mating faces of the valve sections for scratching, pitting, burrs and/or corrosion. Renew valve sections as necessary.
- 2 Check the 'O' ring seatings for scratching, pitting, burrs and/or corrosion. Renew valve sections as necessary.

When Assembling

Note: Lubricate all seals and 'O' rings with hydraulic fluid on assembly.

- 1 Slide the valve section onto the tie rods **C** in the correct order and orientation, fitting new 'O' rings **D**.
- 2 Fit nuts **A** to tie rods **C**. Lay the valve onto a smooth surface and progressively tighten the nuts to the specified torque setting, checking for correct section alignment as the nuts are tightened.

Key

- B** End Cover
- E** Shovel Spool
- F** Lift Spool
- G** End Cover
- H** Blanking Plug

Torque Settings

Item	Nm	kgf m	lbf ft
A	16.7 - 17.7	1.7 - 1.8	12.3 - 13

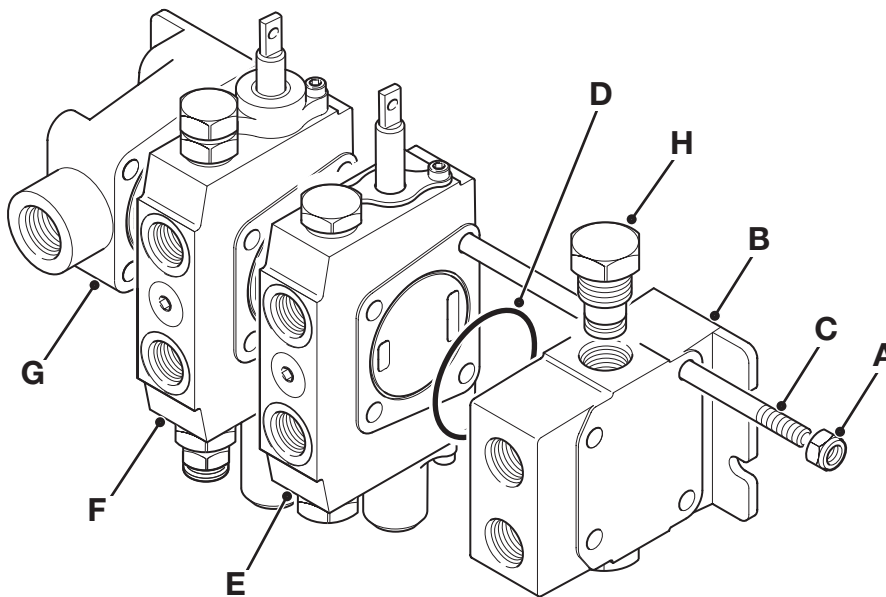

Fig 2.

708151-1

Excavator Valve

Removal and Replacement

Removal

⚠ WARNING

Hydraulic Pressure

Hydraulic fluid at system pressure can injure you. Before disconnecting or connecting hydraulic hoses or couplings, vent the pressure trapped in the hoses in accordance with the instructions given in this publication.

HYD-1-5

Before working on the hydraulic system ensure that the engine is switched off and the starter key removed.

Operate the control levers to vent the hydraulic pressure.

Drain the hydraulic tank.

Remove the cowling from around the valve block.

Disconnect the control levers from the tops of the valve spools **1**.

Disconnect all hydraulic hoses from the valve ports (one inlet **A**, one high pressure carry-over port **B**, twelve work ports **C** and one outlet **D**). Cover exposed connections to prevent ingress of dirt. Mark the hoses to ensure correct reconnection.

Remove the securing nuts and bolts **2** and lift the valve block **3** from the machine.

Replacement

Replacement is a reversal of the removal procedure.

If a new valve block is being fitted it will be necessary to transfer the adapters from the old valve block. Use new 'O' rings.

Ensure all hoses and ports are clean and free from dirt.

Torque Settings

Item	Nm	kgf m	lbf ft
2	56	5.7	42

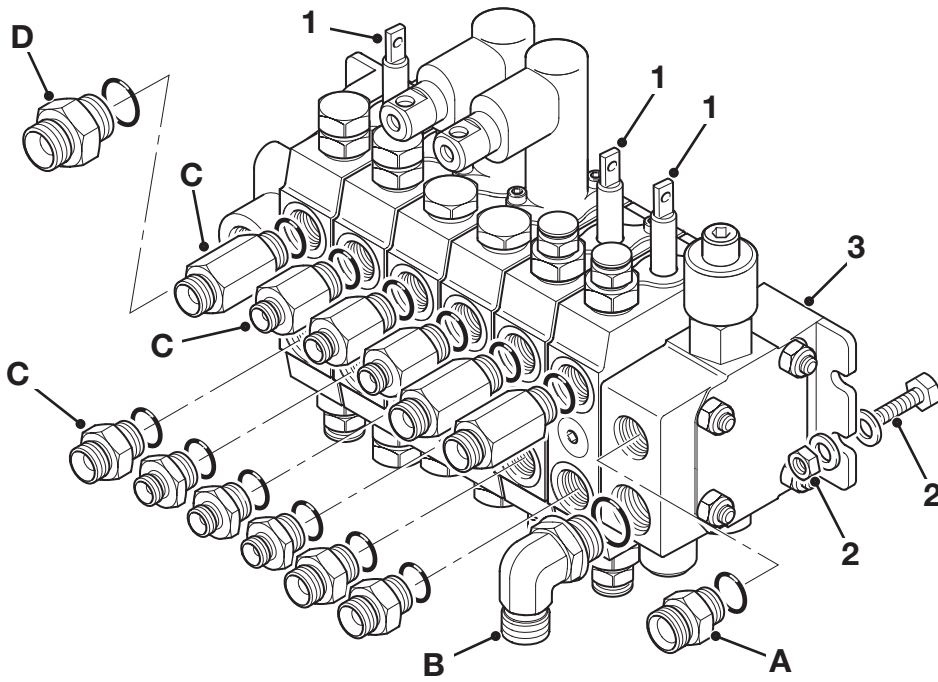

Fig 3.

708220-1