

## COMPONENT OPERATION / Swing Device

### SWING MOTOR

The swing motor consists of swash plate (9), rotor (12), valve plate (13), housing (11) and swing parking brake (springs (1), brake pistons (2), plate (3), friction plate (5) and swing parking brake selection valve (4)). Shaft (8) is splined to rotor (12) into which plunger (6) is inserted.

When pressure oil is supplied from the pump, plunger (6) is pushed. Shoe (10) at the top of plunger (6) slides over swash plate (9) so that rotor (12) rotates. The top of shaft (8) is splined to the first stage sun gear of swing reduction gear. Therefore, the rotation of shaft (8) is transmitted to the swing reduction gear.

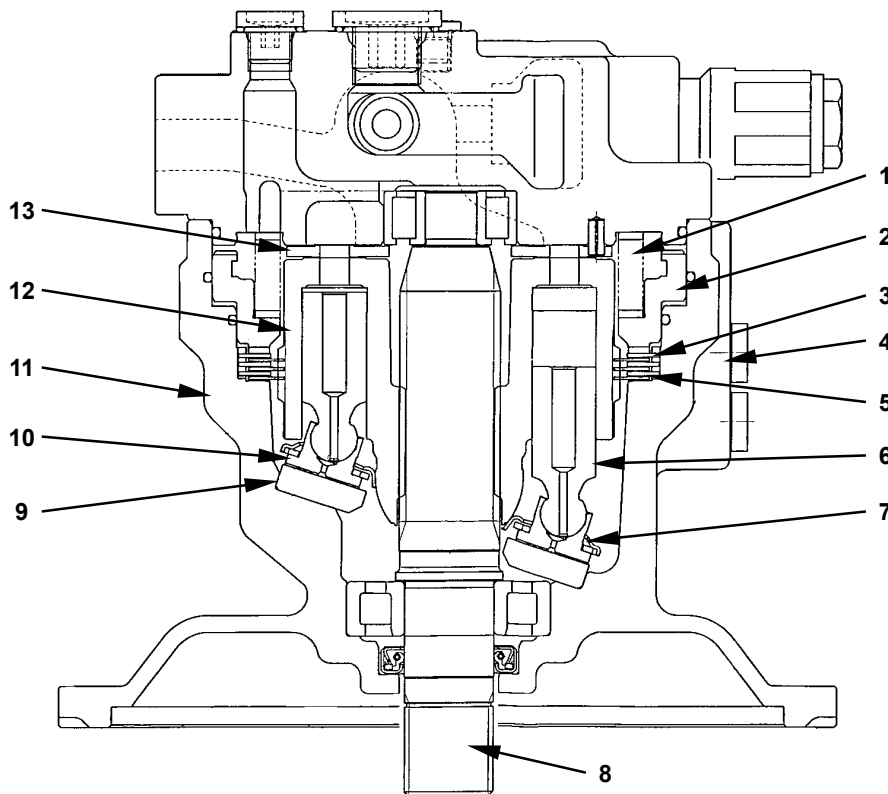

T1V1-03-02-008

- |   |                    |                 |                  |
|---|--------------------|-----------------|------------------|
| 1 - Spring                              | 5 - Friction Plate | 8 - Shaft       | 11 - Housing     |
| 2 - Brake Piston                        | 6 - Plunger        | 9 - Swash Plate | 12 - Rotor       |
| 3 - Plate                               | 7 - Retainer       | 10 - Shoe       | 13 - Valve Plate |
| 4 - Swing Parking Brake Selection Valve |                    |                 |                  |