

## UPPERSTRUCTURE / Pilot Shut-Off Valve

### Removal

1. Remove bolts (1) (6 used) to remove under cover (2).

 : 19 mm

2. Remove spring (5).

### IMPORTANT: Attach identification tags on all disconnected hoses for reassembly.

3. Disconnect hoses (8 to 18). Attach a cap on each disconnected hose end.

 : 17 mm, 19 mm

4. Remove spring pin (7) to remove lever (3).

5. Remove bolts (4) (2 used) to remove pilot shut-off valve (6).

 : 17 mm

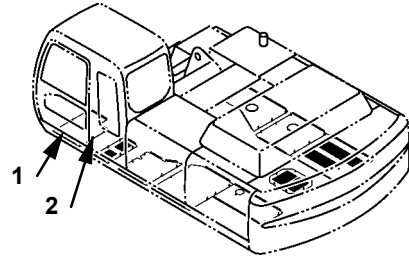

WIHH-02-07-002

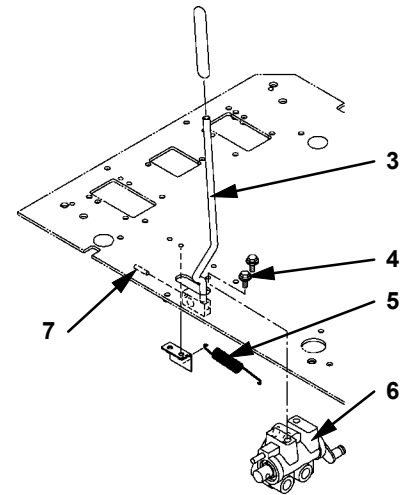

W178-02-08-001

### Installation

1. Install pilot shut-off valve (6) with bolts (4) (2 used).

 : 17 mm

 : 50 N·m (5.1 kgf·m, 37 lbf·ft)

2. Install lever (3) with spring pin (7).

3. Connect hoses (8 to 18).

 : 17 mm

 : 24.5 N·m (2.5 kgf·m, 18 lbf·ft)

 : 19 mm

 : 29.5 N·m (3 kgf·m, 24.5 lbf·ft)

4. Install spring (5).

5. Install under cover (2) with bolts (1) (6 used).

 : 17 mm

 : 50 N·m (5.1 kgf·m, 37 lbf·ft)

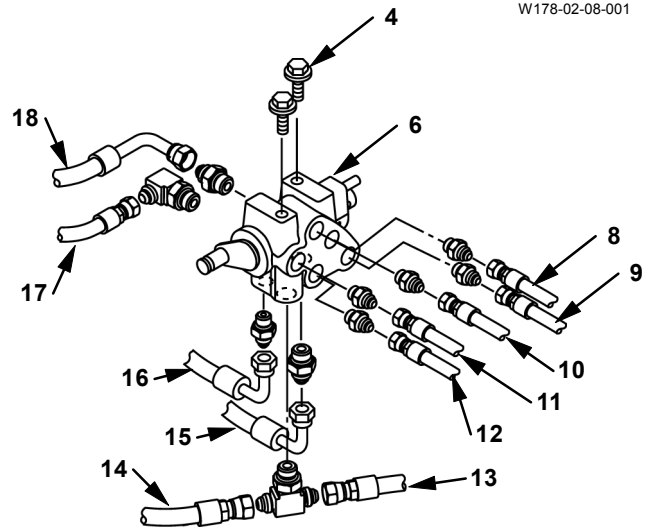

W16J-02-08-001

- 8 - A1 port: Hose P2: To P port in left pilot valve
- 9 - A3 port: Hose P3: To P port in right pilot valve
- 10 - A2 port: Hose P1: To P port in travel pilot valve
- 11 - T1 port: Hose T4: From T port in travel pilot valve
- 12 - T2 port: Hose T5: From T port in left pilot valve
- 13 - T3 port: Hose T6: From T port in right pilot valve
- 14 - T3 port: Hose D4: From 5Pb3 port in control valve 5-spool side
- 15 - P port: Hose PC: From A port in check valve
- 16 - A5 port: Hose PH: To PH port in signal control valve
- 17 - T4 port: Hose DP: To hydraulic oil tank
- 18 - A4 port: Hose PI: From PI port in signal control valve